

ashirvad

by aliaxis

**WORLD'S
LARGEST SELLING
CPVC Pipes & Fittings**

CPVC PLUMBING SYSTEM

HOT WHEN YOU WANT IT. COLD WHEN YOU NEED IT.
TECHNICAL MANUAL



First in India to obtain ISI mark on CPVC pipes SDR 11 & 13.5 sizes from 15 mm - 50 mm



Design Registered Only with Ashirvad

WARRANTY APPLICABLE ONLY IF ASHIRVAD FLOWGUARD[®] PLUS[™] PIPES, FITTINGS & CPVC SOLVENT CEMENT ARE USED.

FLOWGUARD[®] PLUS[™]
CPVC PLUMBING SYSTEMS[™]

FLOWGUARD is the registered mark of The Lubrizol Corporation.
The Lubrizol Corporation is a Berkshire Hathaway Company.

Ideal for hot and cold water plumbing

Ashirvad is a licensee of Lubrizol - USA,
manufacturing and marketing FLOWGUARD® PLUS™
CPVC (Chlorinated Polyvinyl Chloride) hot and cold
water plumbing systems in India.



Raw material from
Lubrizol Advanced
Materials



Alignment system
Design registered
only with Ashirvad



To date Ashirvad has produced
3,76,000 kilometres of CPVC pipes -
that can wrap the earth 7 times over!



FLOWGUARD[®] PLUS
CPVC PLUMBING SYSTEMS[™]

FLOWGUARD is the registered mark of The Lubrizol Corporation.
The Lubrizol Corporation is a Berkshire Hathaway Company.



Index

01

About Ashirvad	09
Certifications	10
About Aliaxis	11
10 Assurances	16

02

What is CPVC?	19
Why Only CPVC?	20
Why Only Ashirvad FLOWGUARD® PLUS™?	22
Standards and Codes	23
Basic Properties of Ashirvad FLOWGUARD® PLUS™	25

03

Dimensional Details	26
---------------------	----

04

Quality Control Procedures at Ashirvad	31
Handling and Storage	32
Solvent cement Instructions	33

05

Fittings - Dimensions	40
Thermal Expansion and Contraction	51
Horizontal and Vertical Spacing in Installation	52
Frictional Head Loss Table	53
Frequently Asked Questions	54
Warranty and Incompatibility	57

Water - In all its forms,
a precious gift to life around,
ever flowing, never stopping,
always forward bound.

From the sky, from the rivers,
from the lakes around
Bringing joy, bringing cheer
abundant & profound
Water, water everywhere,
happiness abound

“Khushiyon ke rang - paani ke sang”

be **water happy**[™]





ashirvad

160MM O.D. S.W.R. SILENT PLUS PIPES 10dB/2LPS TESTED TO EN 14366.

ashirvad

110MM O.D. S.W.R. SILENT PIPES 13dB/2LPS TESTED TO EN 14366.

ashirvad SDR 11 **FLOWGUARD PLUS**

ashirvad SDR 11 **FLOWGUARD PLUS**

ashirvad

AQUALIFE™ (DN 20mm) 3/4" uPVC ASTM - D - 1785 SCHD 40 LEAD FREE

ashirvad

SUPER HEAVY CLASS

ashirvad

STANDARD CLASS

About Ashirvad

Ashirvad an Aliaxis group company, setup its Bengaluru unit in 1998 and is a wholly owned company of Aliaxis group. Aliaxis group is a global leading manufacturer and distributor of plastic fluid handling systems used in residential, commercial and industrial buildings. Aliaxis, headquartered in Brussels and is present over 45 countries with more than 100 manufacturing and commercial entities, employs over 16,000 people and generates more than 3 billion Euro (₹ 21, 600 crores approx) in annual sales.

Ashirvad has always been relentless in its commitment to quality and services. Ashirvad pipes is a leading manufacturer and supplier of CPVC, uPVC, SWR plumbing systems and also the pioneer in designing and manufacturing of uPVC column pipes, which are used in the erection of submersible borehole pumps. Today Ashirvad Pipes is the world's largest manufacturer of uPVC column pipes and successfully exporting to 40+ countries. The CPVC Hot and Cold plumbing system is manufactured in collaboration with Lubrizol, USA.

Ashirvad is an ISO 9001:2015, ISO 14001:2015 and ISO 45001:2018 certified company with a constant endeavour towards achieving the highest level of customer satisfaction.

Ashirvad, with a determination to be a one-stop-shop for Plumbing, Agriculture, Sanitary, High-rise and Fire Safety solutions, has recently expanded its product range and successfully introduced Agri Pipe, Casing Pipe, BlazeMaster® Pipes & Fittings by Ashirvad.

Capabilities:

- Manufacturing capacity of more than 2,00,000 MT per annum
- Total factory area of 50 acres
- 500+ Strong Sales & marketing staff across India
- Strong team of 205 at corporate office
- Over 4,500 manufacturing workforce
- 11 warehouses, 1,100 distributors, 53,000 dealers across India
- Exporting Column Pipes to more than 40 countries
- 2 factories in Bengaluru and another one in Bhiwadi (Rajasthan) near Delhi



In 2007, Ashirvad won the National Award for "OUTSTANDING ENTREPRENEURSHIP IN MEDIUM ENTERPRISES"

The award was presented by the Prime Minister of India.



WCRC Leaders Summit - 2014

Ashirvad Pipes

"One Of The 100 Fastest Growing Marketing Brands In Asia"

(Evaluated and selected by KPMG)
The Global Audit Firm



Construction Industry Database (CIDC) - 2016 Has been enlisted as an **Approved Vendor** for providing the following Services / Products
Manufacturing of
CPVC & uPVC Pipes & Fittings

Certifications

intertek
The Quality Assured

CERTIFICATE OF REGISTRATION

This is to certify that the management system of
Ashirvad Pipes Pvt. Ltd.

Site 1: Plot No. 4, B, 26 & 26 B Attibele Industrial Area, Hosur Road, Bangalore - 562107, Karnataka, India
Site 2: Plot No. 27, 28, 29 & 30, Bommasandra-Igani Link Road, Industrial Area, Igani Hobli, Ankal Taluk, Bangalore - 560055, Karnataka, India
Site 3: Plot No. SP1-177 & 178, Kabanji Industrial Area, Bhiwad Extension, Dis. Alwar - 301025 Rajasthan, India

has been registered by Intertek as conforming to the requirements of
ISO 45001:2018

OHAS 18001:2007 certified from 20 July 2017 to 27 February 2019.

The management system is applicable to:
Manufacture and Supply of uPVC & CPVC Pipes and Fittings and Solvent Cement for Industrial, Domestic, Agriculture, Sewage Applications.

Certificate Number: 0087730
Initial Certification Date: 20 July 2017
Date of Certification Decision: 27 February 2019
Issuing Date: 28 February 2019
Valid until: 28 February 2022

U.K.A.S. UKAS

Calin Moldoveanu
President Business Assurance

Intertek Certification Limited, 15A Victory Park, Victory Road, Derby DE24 0EJ, United Kingdom
Intertek Certification Limited is a UKAS accredited body under a schedule of accreditation no. 024

intertek
The Quality Assured

CERTIFICATE OF REGISTRATION

This is to certify that the management system of:
Ashirvad Pipes Pvt. Ltd.

Site 1: Plot No. 4, B, 26 & 26 B Attibele Industrial Area, Hosur Road, Bangalore - 562107, Karnataka, India
Site 2: Plot No. 27, 28, 29 & 30, Bommasandra-Igani Link Road, Industrial Area, Igani Hobli, Ankal Taluk, Bangalore - 560055, Karnataka, India
Site 3: Plot No. SP1-177 & 178, Kabanji Industrial Area, Bhiwad Extension, Dis. Alwar - 301025 Rajasthan, India

has been registered by Intertek as conforming to the requirements of
ISO 9001:2015

The management system is applicable to:
Manufacture and Supply of uPVC & CPVC Pipes and Fittings and Solvent Cement for Industrial, Domestic, Agriculture, Sewage Applications.

Certificate Number: 0087727
Initial Certification Date: 22 April 2015
Date of Certification Decision: 27 February 2019
Issuing Date: 28 February 2019
Valid until: 28 February 2022

U.K.A.S. UKAS

Calin Moldoveanu
President Business Assurance

Intertek Certification Limited, 15A Victory Park, Victory Road, Derby DE24 0EJ, United Kingdom

intertek
The Quality Assured

CERTIFICATE OF REGISTRATION

This is to certify that the management system of:
Ashirvad Pipes Pvt. Ltd.

Site 1: Plot No. 4, B, 26 & 26 B Attibele Industrial Area, Hosur Road, Bangalore - 562107, Karnataka, India
Site 2: Plot No. 27, 28, 29 & 30, Bommasandra-Igani Link Road, Industrial Area, Igani Hobli, Ankal Taluk, Bangalore - 560055, Karnataka, India
Site 3: Plot No. SP1-177 & 178, Kabanji Industrial Area, Bhiwad Extension, Dis. Alwar - 301025 Rajasthan, India

has been registered by Intertek as conforming to the requirements of
ISO 14001:2015

The management system is applicable to:
Manufacture and Supply of uPVC & CPVC Pipes and Fittings and Solvent Cement for Industrial, Domestic, Agriculture, Sewage Applications.

Certificate Number: 0087727
Initial Certification Date: 20 July 2017
Date of Certification Decision: 27 February 2019
Issuing Date: 28 February 2019
Valid until: 28 February 2022

U.K.A.S. UKAS

Calin Moldoveanu
President Business Assurance

Intertek Certification Limited, 15A Victory Park, Victory Road, Derby DE24 0EJ, United Kingdom

भारत सरकार
GOVERNMENT OF INDIA
सहानि उद्योग मंत्रालय
MINISTRY OF COMMERCE & INDUSTRY
विदेश व्यापार मानदिसालय
DIRECTORATE GENERAL OF FOREIGN TRADE
मानक प्रमाण पत्र
Certificate of Recognition
एक स्टार निर्यात सदन
ONE STAR EXPORT HOUSE

कै.सं. 01/2015-2020 और आयात पत्र
को प्रिडित सदन के लिए 2015-2020 के प्रमाणपत्र के अनुसार एक निर्यात निर्यात सदन का सदन प्रमाण पत्र प्राप्त है। यह प्रमाण पत्र, प्रिडित प्रमाण (2015-2020) के लिए 3.20 (क) के तहत सदन के निर्यात-आयात के लिए वैध है। (क) के तहत है।

M/s. ASHIRVAD PIPES PVT. LTD.
PLOT NO. 4, B, 26 & 26 B, ATTIBELE INDUSTRIAL AREA, HOSUR ROAD, BANGALORE - 562107, KARNATAKA, INDIA

and Income Tax PAN
are hereby accorded the status of One Star Export House in accordance with the provisions of the Foreign Trade Policy, 2015-2020. This Certificate is valid for a period of 05 years effective from 28/02/2019 to 28/02/2024. Subject to the conditions prescribed in Para 3.20(b) of the Handbook of Procedures (2015-2020).

म.सं. 01/2015-2020
दि. 28/02/2019

आयात/निर्यात प्रमाणपत्र
डिप्टी सचिव/विदेश व्यापार (म.सं. 01/2015-2020)
अतिरिक्त ज्यूनियर सचिव
विदेश व्यापार मंत्रालय (म.सं. 01/2015-2020)

पुणेकर मंडळ लिमिटेड
भारतीय मानक ब्यूरो
BUREAU OF INDIAN STANDARDS
PAN No. : AAATB04310

किस इजाजतपत्र प्रमाण, पत्रों की सेवा
पुणे, महाराष्ट्र - 411 007
Pune Industrial Area, 1st Stage, Tandon Road, Bangalore - 560 008

REGISTRATION No. 4497178
Date: 18 Feb 2014

Our Ref: BINO/I-332309
Subject: RENEWAL OF CERTIFICATION MARKS LICENSE NO. CML/I-332309
AS PER IS 15778:2007
M/s. ASHIRVAD PIPES PVT. LTD.
4-B, ATTIBELE INDUSTRIAL AREA, HOSUR ROAD, BANGALORE-562107, DIST. - BANGALORE URBAN, KARNATAKA.

Dear Sir,
With reference to your application for renewal of the above mentioned Certification Marks License, we are pleased to inform you that it has been renewed from 22/02/2014 to 21/02/2015.

It may please be noted that your license shall expire at the end of the above mentioned period. You are, therefore, requested to send your application for its renewal at least two months before the expiry of the license.

The endorsement sheet No.4 regarding renewal of license is enclosed. This may be annexed to the original license document available with you.

You are also requested to subscribe to our monthly Technical Journal 'Handbook India' and also make use to publicize your product through advertisements. The details of advertisement charges and subscription rates are available in our website www.bis.org.in

Thanking you,
Yours faithfully,
J. K. SHARMA
SCIENTIST-E

Enc: As above

पुणेकर मंडळ लिमिटेड, 9 सहाय्यक जल मार्ग, नू रिडी 411 007
Head Quarters, Market Bazaar, 9 Sahayyaka Jal Marg, New Delhi 110 002
E-mail - info@bis.org.in

पुणेकर मंडळ लिमिटेड
भारतीय मानक ब्यूरो
BUREAU OF INDIAN STANDARDS
PAN No. : AAATB04310

किस इजाजतपत्र प्रमाण, पत्रों की सेवा
पुणे, महाराष्ट्र - 411 007
Pune Industrial Area, 1st Stage, Tandon Road, Bangalore - 560 008

REGISTRATION No. 4497178
Date: 18 Feb 2014

Our Ref: BINO/I-4497178
Subject: RENEWAL OF CERTIFICATION MARKS LICENSE NO. CML/I-4497178 held by you for Specification for CPVC pipes for soil and waste discharge systems inside buildings including ventilation and rainwater systems as per IS 15992 : 1992 which is valid upto 06/09/2014.

Dear Sir,
This is reference to BIS Certification Marks License No. CML/I-4497178 held by you for Specification for CPVC pipes for soil and waste discharge systems inside buildings including ventilation and rainwater systems as per IS 15992 : 1992 which is valid upto 06/09/2014.

We are pleased to inform you that the Competent Authority of Bureau has agreed to include the following variety in your license with immediate effect:

Specification for CPVC pipes for soil and waste discharge systems inside buildings including ventilation and rainwater systems as per the following tables:

Size of DN 40mm to 110mm, Type A and Type B Shading Socket.

Please inform us as and when you start making the new variety. You are advised to maintain separate records for the above variety after testing the same as per IS11.

Enclosure sheet No.3 for the above is enclosed.

Thanking you,
Yours faithfully,
J. K. SHARMA
SCIENTIST-E

Enc: As above

पुणेकर मंडळ लिमिटेड, 9 सहाय्यक जल मार्ग, नू रिडी 411 007
Head Quarters, Market Bazaar, 9 Sahayyaka Jal Marg, New Delhi 110 002

संयुक्त इन्स्टीट्यूट ऑफ प्लास्टिक इंजीनियरिंग एण्ड टेक्नोलॉजी
CENTRAL INSTITUTE OF PLASTICS ENGINEERING & TECHNOLOGY
Plastics Testing Centre
No. 0125322

REPORT No. 14024662
PART - C

Issued to: M/s. Ashirvad Pipes Pvt. Ltd., 4-B, Attibele Industrial Area, Hosur Road, Bangalore - 562107. Date: 13.12.2014

Ref: Your Letter No. Nil & Dated 29.11.2014

TEST REPORT AS PER IS 15178:2007
REPORT NO: 14024662
PART A: PARTICULARS OF SAMPLE SUBMITTED

a) Name of the Sample: CPVC Pipes for Potable Hot & Cold Water Distribution supplies

b) Grade/Variety/Type/Size/Class: DN 15 mm, OD 15.90 mm, SER 13.5, Class 2

c) Declared values, if any: Ashirvad FLOWGUARD Plus V² S10

d) Batch No. and Date of Manufacture: CHM214A/04/01A/Nil

e) Quantity: 500 mm Length x 2 No's

f) Mode of Packing: BOPP Bag

g) BIS Std: Nil

h) Any other information: Samples received on 04.12.2014

i) Date of Issuance of report: 05.12.2014

j) Date of Completion of testing: 13.12.2014

PART B - SUPPLEMENTARY INFORMATION

a) Reference to sampling Procedure: Nil

b) Supporting documents for the measurements taken and result derived: Nil

c) Deviation from the test method as prescribed in relevant work instructions, if any: Nil

संयुक्त इन्स्टीट्यूट ऑफ प्लास्टिक इंजीनियरिंग एण्ड टेक्नोलॉजी
CENTRAL INSTITUTE OF PLASTICS ENGINEERING & TECHNOLOGY
Plastics Testing Centre
No. 0125322

REPORT No. 14024662
PART - C

TEST RESULTS IN (AS PER IS 15178:2007)

Sl. No.	Class	Effect on water	Meas. spec. by Meas.	Results obtained
01	3.3	Loss of ph. pipe (After extraction)	1.3 mg/g	0.01%
		Loss of PH. pipe (After extraction)	0.0 mg/g	0.00%
		Extraction as per (Third extraction)	0.07 mg/g	0.007%
		Extraction as per (All three extractions)	0.01 mg/g	Not detected
		Migration as per (All three extractions)	0.001 mg/g	Not detected
		Other toxic substances such as "As-a-crylonitrile or but acrylonitrile monomer" and "Acid anhydride" (Third extraction)	0.01 mg/g	Not detected

PART D - REMARKS - Nil

Nil: 1) The result obtained only for items samples tested.

2) The report shall not be reproduced in full part without written approval of the laboratory.

TECHNICAL MANAGER
QUALITY MANAGER AUTHORIZED SIGNATORY

Phone: 0821-2514972
E-mail: ceo@cftri.res.in

CSIR-Central Food Technological Research Institute
Mysore - 570 020, INDIA
TEST REPORT

PR/ANCL/ATSP/05/CSC/2282614-15
06.01.2015

Name & Address of the Consumer: M/s. Ashirvad Pipes Pvt. Ltd., 4-B, Attibele Industrial Area, Hosur Road, Bangalore - 562 107

Request Reference: Your letter dated 09.12.2014

Name of the Product/Sample: Ashirvad V² (DN: 20 mm) (OD: 22.3mm) CPVC SER 13 Class 1 Flowguard Plus Pipe

Sample Receipt Date: 24.11.2014

Test Parameter	Standard (Toler. Time)	Amount of Extractives		Limits as per IS: 10515-1982 (2007) Positive Test (IN: 01.04.1982) (2007)		Test Method
		mg/litre	ppm	mg/litre	ppm	
Overall Migration Test	Distilled Water (40°C/10days)	0.22	2.2	10	60	9845-2998 (2004)

Concluding: The above tested sample conforms to Overall Migration Test specifications. Limits as per IS: 10515-1982 (2007) Positive Test: IS:10418-1982 (2007) for intended use for contact with potable water at room temperature filling and storing.

Reference as given by the consumer: Please Note: The result contained in this Test Certificate relate only to the sample tested. This Certificate is issued only for your guidance and not valid for legal purposes or for advertisement.

Dr. J. K. Sharma
Food Safety & Analytical Quality Control Laboratory
CFTRI, Mysore

About Aliaxis



Aliaxis group is a leading global manufacturer and distributor of plastic fluid handling systems used in residential, commercial and industrial buildings.

Head quartered in Brussels, Belgium. Aliaxis is present in over 45 countries, has more than 100 manufacturing and commercial entities and employs over 16,000 people.

Aliaxis leverages local and global knowledge of the industry as well as regulations and building habits to provide consistently excellent customer service through distribution partners to builders, installers, infrastructure contractors and others. The group is in the Indian plumbing and sanitary market through a partnership with Ashirvad Pipes since 2013.

Aliaxis at a glance



€ 3.1 billion
Revenue



120+
Distribution centres



1.400+
Injection machines



16.000+
Colleagues



45+
Countries



600+
Extruders



€ 87 million
Capex



80+
Manufacturing sites



10
Commercial brands

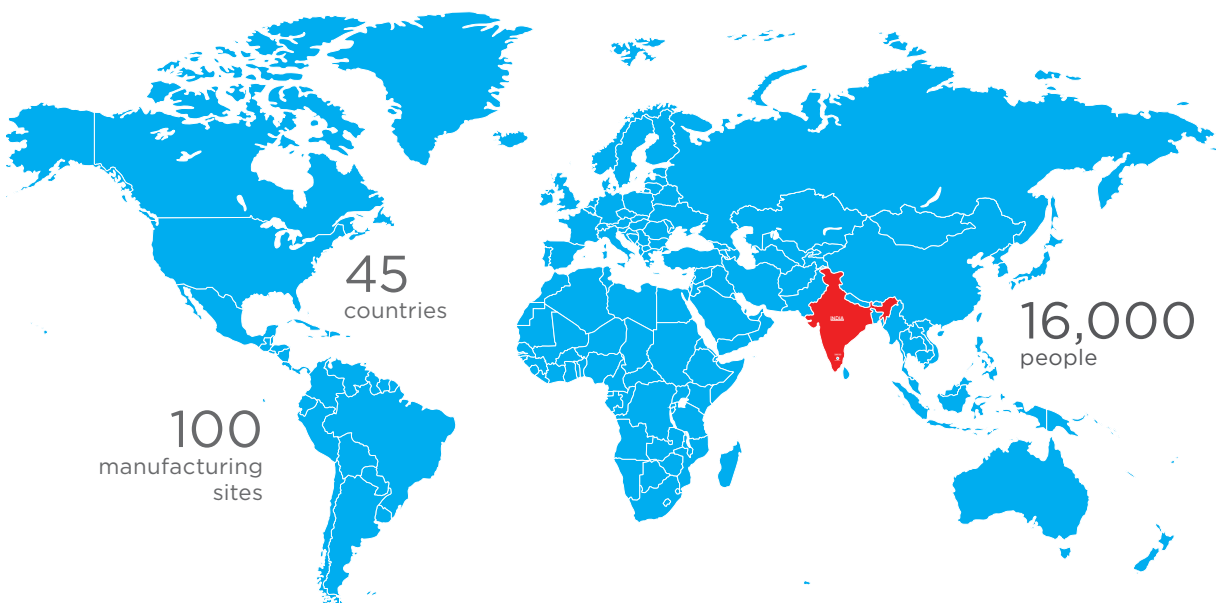





Ashirvad production plant



Injection Moulding Facility



Automated Raw material storage in Silos



Ashirvad workforce



Brass Fittings Quality Control



CPVC Extrusion Facility

10 ASSURANCES

#01

STATE OF THE ART
MANUFACTURING FACILITIES



#02

ADVANCED MACHINERY
FOR SUPERIOR QUALITY

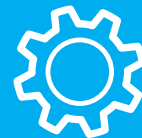

#03

ADVANCED MATERIAL
HANDLING SYSTEMS



#04

100% INCOMING RAW
MATERIAL INSPECTION

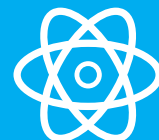

#05

HIGH DIMENSIONAL ACCURACY
TO MAINTAIN QUALITY OF
EACH PIECE, TO ENSURE
A DEFECT FREE SYSTEM



Ashirvad's stringent quality checks ensure premium products and maximum customer satisfaction

#06

STRINGENT QUALITY CHECKS AT EVERY LEVEL OF PRODUCTION

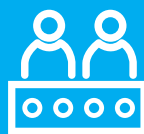

#07

100% FINISHED GOODS INSPECTION



#08

MULTIPLE QUALITY CHECKS IN PLACE FOR EVERY CPVC BRASS FITTING THAT LEAVES THE ASHIRVAD FACTORY



#09

EVERY BATCH OF PRODUCTS LAB TESTED



#10

REGULAR EXTERNAL LAB TESTING OF PRODUCTS IN USA, FRANCE AND INDIA

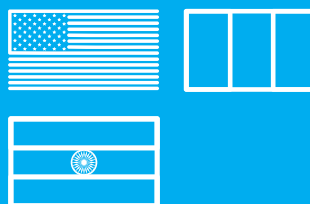

LEAK PROOF BATHROOMS

Ideal for use in hot and cold water applications in villas and individual homes, residential apartments, office complexes, commercial buildings, hotels and hospitals.



What is CPVC?

Chlorinated polyvinyl chloride (CPVC) is a thermoplastic produced by chlorination of polyvinyl chloride (PVC) resin and is used for hot and cold water lines. CPVC is the first choice of material for potable water supply and is in use across the world for more than 50 years. It is ideal for use in hot and cold water applications in villas and individual homes, residential apartments, office complexes, commercial buildings, hotels and hospitals.

CPVC offers the following advantages against other piping materials:



Lowest bacterial growth

As compared to other piping systems (steel, copper, polypropylene, other thermoplastics) the bacterial growth in Ashirvad FLOWGUARD® PLUS™ CPVC is much lower.



No Corrosion, leakage, scaling and pitting

Ashirvad FLOWGUARD® PLUS™ CPVC has excellent corrosion resistance, preventing contamination, bad taste, bad odour and discoloration of the water. With CPVC there is no corrosive by-product ensuring the purest form of water to the very last drop. CPVC systems are unaffected by the low pH of water, coastal air or corrosive soils.



Fire Retardant

Characteristic of Ashirvad FLOWGUARD® PLUS™ CPVC is its outstanding fire safety profile. It will not burn unless an external flame source is present and will not sustain ignition once the flame source is removed.

It has:

- High ignition temperature
- Low toxicity
- Low heat of combustion
- 25/50 flame smoke development rating



Limiting Oxygen Index (LOI)

It must be forced to burn due to its very high Limiting Oxygen Index (LOI) of 60. LOI is the percentage of oxygen needed in an atmosphere to support combustion. Since the Earth's atmosphere contains only 21% oxygen, CPVC will not burn unless a flame is constantly applied, and stops burning when the ignition source is removed.

FEATURES AND BENEFITS OF ASHIRVAD FLOWGUARD® PLUS™ CPVC PIPING SYSTEM

• Quick and easy to install

Ashirvad FLOWGUARD® PLUS™ CPVC is light in weight which reduces the transportation, handling and installation cost. CPVC pipes and fittings have seamless interior walls and require no special tools for cutting.

• Tough and reliable

Highly resilient, tough and durable with high tensile strength and high impact strength.

• Freedom from toxicity, odours and tastes

• Low thermal expansion

• Low thermal conductivity

• Suitable for use up to 93°C

• Energy saving

• Smooth internal surface finish

• UV resistant

Why only CPVC?

Property	Ashirvad FLOWGUARD® PLUS™ CPVC	Copper	GI	PP-R
Corrosion	No effect due to excellent chemical resistance	Will corrode over a period of time	Corrodes faster and deteriorates	Has a certain amount of chemical resistance
Scaling, Pitting and Leaching and full bore flow	Absence of scaling, pittings and leaching leads to full bore flow	Scaling, pitting and leaching leads to reduced bore flow	Severe scaling, pitting and leaching leads to reduced bore flow	Scaling, pitting and leaching can occur and reduce bore flow in some instances
Thermal conductivity and insulation levels	Lower thermal conductivity reduces heat loss and requires reduced insulation levels	Very high thermal conductivity increases heat loss and requires high insulation	Very high thermal conductivity increases heat loss and requires high insulation levels	Higher thermal conductivity than CPVC, leading to heat loss and requires higher Insulation levels.
Bacterial growth	Extremely low	More than CPVC	More than copper	More than CPVC
Fire Resistance	LOI of is 60% and hence does not catch fire or sustain burning	Being metallic, better Fire Resistance	Being metallic, better Fire Resistance	LOI is 18%, hence can easily catch fire and sustain burning
Installation	Easy. Through cold welding, requiring less manhours. No electric / heat source required. Hence cost effective	Requires highly skilled manpower and electric / heat source	Very slow and cumbersome. Requires more man hours	Jointing process is by heat fusion. Requires greater skill and electric/ heat source
Leakage	Leakfree installation for the entire life span of the piping system	Leakfree, provided carried out by highly trained manpower	Always susceptible to leakage from day one of installation	Relatively leak free if highly skilled manpower is employed
Thermal Expansion	Lower. Leads to less pipe expansions, less looping and offsets	Although thermal expansion is lower, the stress induced is far greater.	Although thermal expansion is lower, the stress induced is far greater	Higher expansion requires more looping/offsets
Range of Fittings	Wide range of fittings makes layout easier and compact for Architects, consultants, builders and end users	Limited range of fittings involves frequent cutting / welding to achieve the desired layout	Limited range of fittings	Nominal range of fittings
Special Tools	Simple cutter or saw blade and CPVC solvent cement is adequate for 100% leak-proof joint and satisfactory plumbing	Needs special tools like metal cutting flame torch, solder, flux, etc. to carry out the desired plumbing	Needs heavy tools for pipe cuttings and threading	Needs special electrical heater to achieve the desired hot welded joint. Any failure can result in poor plumbing and therefore leakages
Specialities	Wall mixer adaptors, Water hammer arrestor, Single lever diverter etc.	Water hammer arrestor	None	Can be possible



Why only Ashirvad FLOWGUARD® PLUS™?

Features and Benefits

Ashirvad FLOWGUARD® PLUS™

Raw material has a successful track record of over 50 years – across the globe	Yes
Raw material has been used in the highest number of projects in India over the last 14 years	Yes
TempRite® CPVC Raw material is NSF certified	Yes
Widest range of pipes and fittings from ½” to 6” and assemblies	Yes
Consistent lab testing in Europe, USA and India	Yes
Tested and proven for over 14 years in Indian conditions	Yes
Nationwide trained marketing and support team	Yes
Factory warranty on all products	Yes

THE SUPERIOR HOT/COLD WATER DISTRIBUTION SYSTEM

When you specify FLOWGUARD® PLUS™ pipes and fittings, you benefit from the most experienced installation and support network in the industry. Let us help you specify the pipes, fittings, solvent cement and installation technologies that meet your most stringent standards for reliability and performance.

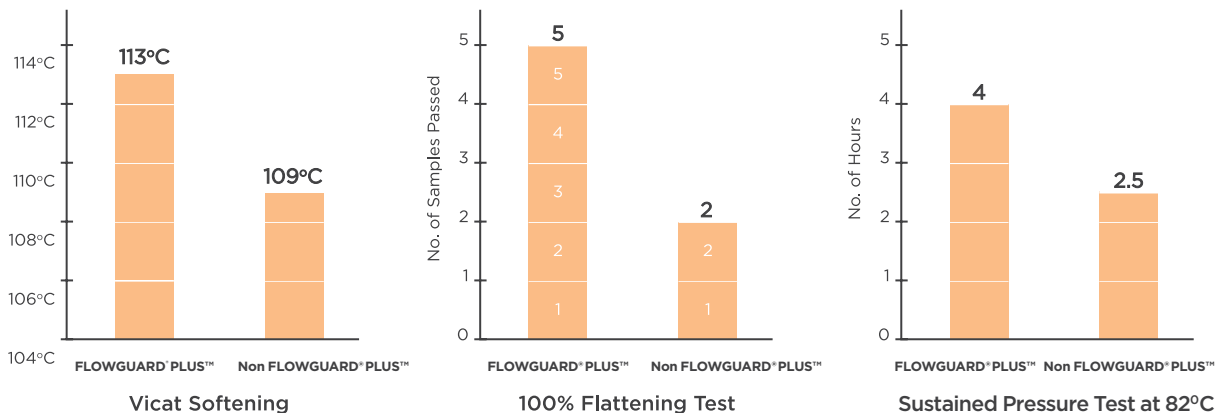

Parameters	Ashirvad FLOWGUARD® PLUS™ Pipes and Fittings	Pipes & Fittings Processed From Non FLOWGUARD® PLUS™ Material	Remarks
Vicat Softening	Pass	Fail	Generic CPVC product has continuous problem in hot water lines.
Vice Crush / Flattening Test	Pass	Fail	In generic CPVC product, material is inconsistent which weakens pipe and has high risk of pipe failure.
Verification of the Malfunction Temp. at 95°C	Pass	Fail	Generic CPVC product has less life expectancy.
Manufacturing Process	Pass	Fail	FLOWGUARD® PLUS™ pipes have strong quality control and has no batch to batch variation.
Specification and Code Acceptance	Pass	Fail	FLOWGUARD® PLUS™ pipe is strong on technical grounds and is a well accepted brand.
Product Consistency	Pass	Fail	FLOWGUARD® PLUS™ pipe assures product uniformity

Standards and Codes

STANDARDS FOR PIPES AND FITTINGS

FLOWGUARD® PLUS™ CPVC pipes and fittings are manufactured in sizes from ½” to 6”.

Class of Pipe	Standard	Sizes available	Class of Fitting	Standard	Sizes available
Class-1 / SDR 11 Pipe	IS 15778 : 2007 ASTM D 2846 : 2011	½” - 2”	SDR 11 Fittings	ASTM D 2846 : 2011	½” - 2”
Class-2 / SDR 13.5 Pipe	IS 15778 : 2007	½” - 2”	SCH 40 Fittings	ASTM F 438 : 2009	2½” - 6”
SCH 40 Pipe	ASTM F 441 : 2013	2½” - 6”	SCH 80 Fittings	ASTM F 439 : 2013	2½” - 4”
SCH 80 Pipe	ASTM F 441 : 2013	2½” - 6”			

COLOUR CODING OF PIPES AND FITTINGS

FLOWGUARD® PLUS™ CPVC pipes and fittings can be easily distinguished by the manufacturer’s trademark and appropriate colour coding on the product.

Class of Pipe	Colour	Class of Fitting	Colour
Class-1 / SDR 11 PIPE	Tan red stripe with logo	SDR 11 FITTINGS	Tan
Class-2 / SDR 13.5 PIPE	Tan brown stripe with logo	SDR 11 FITTINGS	Tan
SCH 40 PIPE	Tan brown stripe	SCH 40 FITTINGS	Tan
SCH 80 PIPE	Tan red stripe	SCH 80 FITTINGS	Tan

FLOWGUARD® PLUS™ CODE COMPLIANCE

Code	Organisation
BOCA National Plumbing Code	Officials and Code Administrational, Inc.
National Standard Plumbing Code	National Association of Plumbing-Heating-Cooling Contractors
Standard Plumbing Code	Southern Building Code Congress International, Inc
Uniform Plumbing Code	International Association of Plumbing and Mechanical Officials
CAB01 and 2 Family Dwelling Code	Council of American Building Officials

CERTIFICATIONS FOR ASHIRVAD FLOWGUARD® PLUS™ CPVC PIPES, FITTINGS & SOLVENT CEMENT

NSF / ANSI 61	IAPMO - India	India	Pipes and Solvent Cement
BIS	Bureau of India Standards	India	Pipes
CFTRI	Central Food Technological Research Institute	India	Pipes and Fittings
CIPET	Central Institute of Plastics Engineering and Technology	India	Pipes, Fittings and Solvent Cement
UIPC-I	Uniform Illustrated Plumbing Code - India	India	Pipes, Fittings and Solvent Cement

UIPC-I Certification from IAPMO - India
(International Association of Plumbing and Mechanical Officials - India)

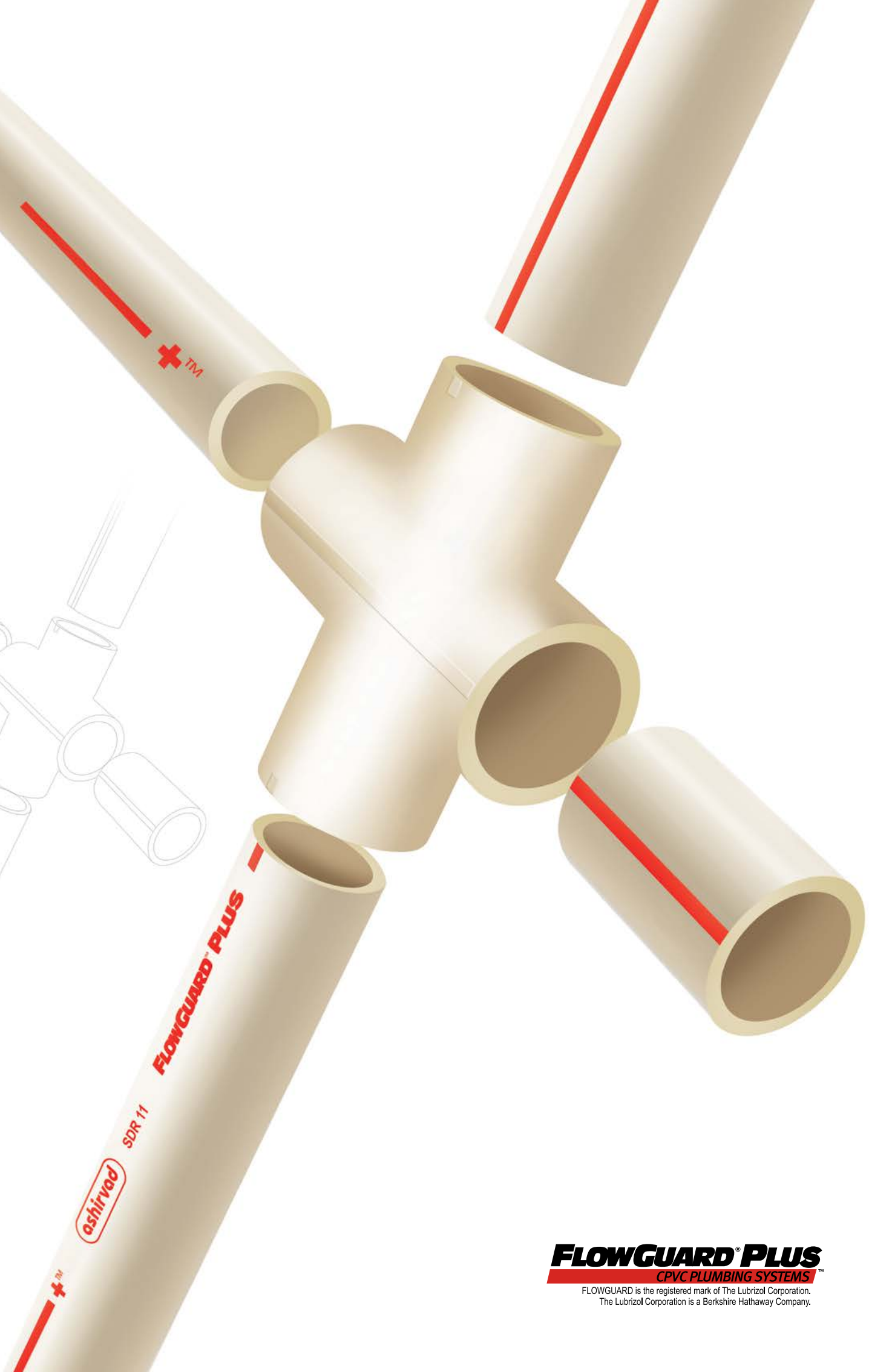

FLOWGUARD[®] PLUS
CPVC PLUMBING SYSTEMS[™]

FLOWGUARD is the registered mark of The Lubrizol Corporation.
The Lubrizol Corporation is a Berkshire Hathaway Company.

Basic Properties of FLOWGUARD® PLUS™ CPVC

Sl.No.	Property	Test	Condition	English Units	S.I. Units
--------	----------	------	-----------	---------------	------------

General

1	Specific Gravity	ASTM D792	73°F/23°C	1.50 - 1.53	1.50 - 1.53
2	Specific Volume	-	73°F/23°C	0.645 cm ³ /g	0.645 cm ³ /g
3	Water Absorption	ASTM D570	73°F/23°C 212°F/100°C	0.03% 0.55%	0.03% 0.55%
4	Rockwell Hardness	ASTM D785	73°F/23°C	119	-
5	Cell Classification	ASTM D1784	-	23447	-

Mechanical

1	Izod impact	ASTM D256	73°F/23°C	1.5 ft lbs/in. o.n	80 J/m o.n
2	Tensile Strength	ASTM D638	73°F/23°C	8000 psi	55 N/mm ²
3	Tensile Modulus	ASTM D638	73°F/23°C	360,000 psi	2500 N/mm ²
4	Flexural strength	ASTM D790	73°F/23°C	15,100 psi	104 N/mm ²
5	Flexural modulus	ASTM D790	73°F/23°C	415,000 psi	2860 N/mm ²
6	Compressive strength	ASTM D695	73°F/23°C	10,100 psi	70 N/mm ²
7	Compressive Modulus	ASTM D695	73°F/23°C	196,000 psi	1350 N/mm ²

Thermal Properties

1	Coefficient of Thermal Expansion	ASTM D696	-	3.4x10 ⁻⁵ in/in/°F	6.1x10 ⁻⁵ m/m/K
2	Thermal Conductivity	ASTM C177	-	0.95 BTU in/hr/ft ² /°F	0.14Wm/K/m ²
3	Heat Distortion Temperature	ASTM D648	-	217°F	103°C
4	Heat capacity	DSC	73°F/23°C 212°F/100°C	0.21 BTU/lb°F 0.26 BTU/lb°F	0.90 J/gK 1.10 J/gK

Flammability

1	Flammability rating	UL94	-	0.062 in/0.157cm	V-0,5VB, 5VA
2	Flame spread	ASTM E84	-	15	
3	Smoke developed	ASTM E84	-	70-125	-
4	Limiting oxygen index	ASTM D2863	-	60%	-

Electrical

1	Dielectric Strength	ASTM D147	-	1250 V/mil	492,000 V/cm
2	Dielectric Constant	ASTM D150	60 Hz, 30°F/-1°C	3.7	3.7
3	Power Factor	ASTM D150	1000 Hz	0.007%	0.007%
4	Volume Resistivity	ASTM D257	73°F/23°C	3.4x10 ¹⁵ ohm/cm	3.4x10 ¹⁵ ohm/cm

Dimensional Details

Dimensional details and Pressure Ratings of SDR 11 (Class 1) CPVC Pipes as per IS 15778 : 2007

Nominal Size (inch)	Mean Outside Diameter (mm)	Average		Wall Thickness		Working Pressure at 27°C		Working Pressure at 82° C	
		(mm)	Tolerance	(mm)	Tolerance	(kg/cm ²)	(MPA)	(kg/cm ²)	(MPA)
½	15	15.90	±0.1	1.95	±0.25	28.14	2.76	6.93	0.68
¾	20	22.20	±0.1	2.25	±0.25	28.14	2.76	6.93	0.68
1	25	28.60	±0.1	2.85	±0.25	28.14	2.76	6.93	0.68
1¼	32	34.90	±0.1	3.45	±0.25	28.14	2.76	6.93	0.68
1½	40	41.30	±0.1	4.05	±0.25	28.14	2.76	6.93	0.68
2	50	54.00	±0.1	5.20	±0.30	28.14	2.76	6.93	0.68

Dimensional details and Pressure Ratings of SDR 13.5 (Class 2) CPVC Pipes as per IS 15778 : 2007

Nominal Size (inch)	Mean Outside Diameter (mm)	Average		Wall Thickness		Working Pressure at 27°C		Working Pressure at 82° C	
		(mm)	Tolerance	(mm)	Tolerance	(kg/cm ²)	(MPA)	(kg/cm ²)	(MPA)
½	15	15.9	±0.1	1.65	±0.25	22.23	2.18	5.61	0.55
¾	20	22.2	±0.1	1.95	±0.25	22.23	2.18	5.61	0.55
1	25	28.6	±0.1	2.35	±0.25	22.23	2.18	5.61	0.55
1¼	32	34.9	±0.1	2.85	±0.25	22.23	2.18	5.61	0.55
1½	40	41.3	±0.1	3.35	±0.25	22.23	2.18	5.61	0.55
2	50	54.0	±0.1	4.30	±0.30	22.23	2.18	5.61	0.55

Dimensional details of CPVC 4120 SCH. 40 Pipes with maximum water pressure rating as per ASTM F 441 : 2013

Nominal Size (inch)	Outside Diameter				Wall Thickness				Pressure at 23°C		Pressure at 83°C
	(mm)	Average (inch)	(mm)	Tolerance (inch)	Minimum (mm)	(inch)	(mm)	Tolerance (inch)	(mm)	PSI (Kg/cm ²)	PSI (Kg/cm ²)
2½	65	2.875	73.03	±0.007	0.18	0.203	5.16	0.024	0.61	300 (21.09)	75 (5.27)
3	80	3.500	88.90	±0.007	0.18	0.216	5.49	0.026	0.66	260 (18.28)	65 (4.57)
4	100	4.500	114.30	±0.008	0.20	0.237	6.02	0.028	0.71	220 (15.47)	55 (3.87)
6	150	6.625	168.28	±0.011	0.28	0.280	7.11	0.034	0.86	180 (12.66)	45 (3.16)

Dimensional details of CPVC 4120 SCH. 80 Pipes with maximum water pressure rating as per ASTM F 441 : 2013

Nominal Size (inch)	Outside Diameter				Wall Thickness				Pressure at 23°C		Pressure at 83°C
	(mm)	Average (inch)	(mm)	Tolerance (inch)	Minimum (mm)	(inch)	(mm)	Tolerance (inch)	(mm)	PSI (Kg/cm ²)	PSI (Kg/cm ²)
2½	65	2.875	73.03	±0.007	0.18	0.276	7.01	+0.033	+0.84	420 (29.53)	105 (7.38)
3	80	3.500	88.90	±0.007	0.18	0.300	7.62	0.036	+0.91	370 (26.01)	90 (6.33)
4	100	4.500	114.30	±0.008	0.20	0.337	8.56	0.040	+1.02	320 (22.49)	80 (5.62)
6	150	6.625	168.28	±0.011	0.28	0.432	10.97	0.052	+1.32	280 (19.69)	70 (4.92)

Tapered socket dimensions for CPVC 4120, SDR 11, Plastic Fittings As per ASTM D 2846 : 2011

Nominal Size (inch)	Socket Entrance Diameter, inch (mm)		Socket Bottom Diameter, inch (mm)		Socket Length inch (mm)	Inside Diameter inch (mm)	Wall Thickness inch (mm)		
	'A' Average	'A' Tolerance	'B' Average	'B' Tolerance	"C" min	"D" min.	Socket Entrance "EA" min.	Socket Bottom "EB" min.	"F"
1/2	0.633 (16.08)	±0.003 (±0.08)	0.619 (15.72)	±0.003 (±0.08)	0.500 (12.70)	0.489 (12.42)	0.068 (1.73)	0.102 (2.59)	0.128 (3.25)
3/4	0.884 (22.45)	±0.003 (±0.08)	0.870 (22.10)	±0.003 (±0.08)	0.700 (17.78)	0.715 (18.16)	0.080 (2.03)	0.102 (2.59)	0.128 (3.25)
1	1.135 (28.83)	±0.003 (±0.08)	1.121 (28.47)	±0.003 (±0.08)	0.900 (22.86)	0.921 (23.39)	0.102 (2.59)	0.102 (2.59)	0.128 (3.25)
1 1/4	1.386 (35.20)	±0.003 (±0.08)	1.372 (34.85)	±0.003 (±0.08)	1.100 (27.94)	1.125 (28.58)	0.125 (3.18)	0.125 (3.18)	0.156 (3.96)
1 1/2	1.640 (41.66)	±0.004 (±0.10)	1.622 (41.20)	±0.004 (±0.10)	1.300 (33.02)	1.329 (33.76)	0.148 (3.76)	0.148 (3.76)	0.185 (4.70)
2	2.141 (54.38)	±0.004 (±0.10)	2.123 (53.92)	±0.004 (±0.10)	1.700 (43.18)	1.739 (44.170)	0.193 (4.90)	0.193 (4.90)	0.241 (6.12)

Tapered socket dimensions for CPVC SCH:40 and SCH: 80, Plastic Fittings As per ASTM F 438 and ASTM F 439 : 2013

Nominal Size (inch)	Socket Entrance Diameter, inch (mm)		Socket Bottom Diameter, inch (mm)		Wall Thickness (mm)				G	J	N
	Diameter	Tolerance	Diameter	Tolerance	SCH: 40		SCH: 80		inch (mm)		
					Wall Thickness at middle of the socket	Wall Thickness at beyond the socket	Wall Thickness at middle of the socket	Wall Thickness at beyond the socket	For SCH: 40 and SCH: 80		
2 1/2	2.889 (73.38)	±0.007 (±0.18)	2.868 (72.85)	±0.007 (±0.18)	0.203 (5.16)	0.254 (6.45)	0.276 (7.01)	0.345 (8.76)	1/2 (38.10)	11/15 (17.46)	3/16 (4.76)
3	3.516 (89.31)	±0.008 (±0.20)	3.492 (88.70)	±0.008 (±0.20)	0.216 (5.49)	0.270 (6.86)	0.300 (7.62)	0.375 (9.53)	1 13/16 (45.04)	3/4 (19.05)	3/16 (4.76)
4	4.518 (114.76)	±0.009 (±0.23)	4.491 (114.07)	±0.009 (±0.23)	0.237 (6.02)	0.296 (7.52)	0.337 (8.58)	0.420 (10.67)	2 5/16 (58.74)	1 (25.4)	3/16 (4.76)
6	6.647 (168.83)	±0.011 (±0.28)	6.614 (168.00)	±0.011 (±0.28)	0.280 (7.11)	0.350 (8.89)	0.432* (10.97)	0.540* (13.72)	3 1/2 (88.9)	1 3/4 (44.45)	1/4 (6.35)

* Not manufactured by Ashirvad Pipes

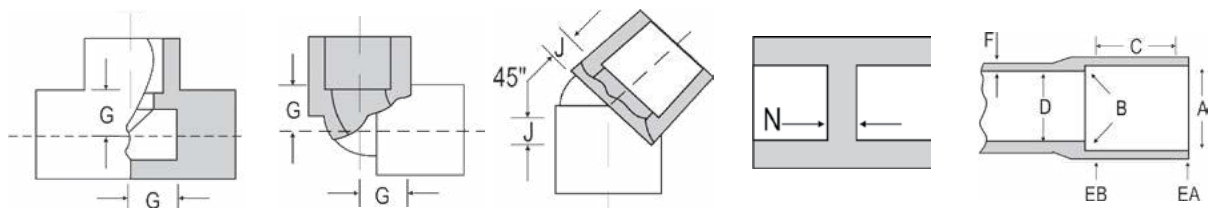

Minimum Dimensions from Center to End of Socket (Laying Length)
for CPVC 4120, SDR 11 Plastic Fittings As per ASTM D 2846 : 2011

Nominal Size (inch)	"G" min. inch (mm)	"J" min. inch (mm)	"N" min. inch (mm)
½	0.382 (9.70)	0.183 (4.65)	0.102 (2.59)
¾	0.507 (12.88)	0.235 (5.97)	0.102 (2.59)
1	0.633 (16.08)	0.287 (7.29)	0.102 (2.59)
1¼	0.758 (19.25)	0.339 (8.61)	0.102 (2.59)
1½	0.884 (22.45)	0.391 (9.93)	0.102 (2.59)
2	1.134 (28.83)	0.495 (12.57)	0.102 (2.59)

Minimum Dimensions from Center to End of Socket (Laying Length)
for CPVC SCH: 40 Plastic Fittings As per ASTM F 438 : 2009

Nominal Size (inch)	"G" min. inch (mm)	"J" min. inch (mm)	"N" min. inch (mm)
2½	1.50 (38.10)	0.69 (17.46)	0.19 (4.76)
3	1.81 (46.04)	0.75 (19.05)	0.19 (4.76)
4	2.31 (58.74)	1.00 (25.4)	0.19 (4.76)
6	3.50 (88.90)	1.75 (44.45)	0.25 (6.35)

Minimum Dimensions from Center to End of Socket (Laying Length)
for CPVC SCH: 80 Plastic Fittings As per ASTM F 439 : 2013

Nominal Size (inch)	"G" min. inch (mm)	"J" min. inch (mm)	"N" min. inch (mm)
2½	1.50 (38.1)	0.69 (17.5)	0.19 (4.8)
3	1.81 (46.0)	0.75 (19.1)	0.19 (4.8)
4	2.31 (58.7)	1.00 (25.4)	0.19 (4.8)

Pressure Rating Comparison between
FLOWGUARD® PLUS™ and Non FLOWGUARD® PLUS™

FLOWGUARD® PLUS™		Non FLOWGUARD® PLUS™	
Pressure Ratings	ASTM Cell Class	ASTM Cell Class	Pressure Ratings
8.711 kg/cm ² @ 82°C 28.1 kg/cm ² @ 23°C	23447 ← SDR 11 →	23447	7.03 kg/cm ² @ 82°C 28.1 kg/cm ² @ 23°C
7.03 kg/cm ² @ 82°C 22.5 kg/cm ² @ 23°C	23447 ← SDR 13.5 →	23447	5.62 kg/cm ² @ 82°C 22.5 kg/cm ² @ 23°C

Temperature Derating Factors
at Working Pressure for CPVC pipe

Working Temperature		Pipe Derating Factors	
°F	°C	FLOWGUARD® PLUS™	Non FLOWGUARD® PLUS™
73 - 80	23 - 27	1.00	1.00
90	32	0.91	0.91
100	38	0.83	0.82
120	49	0.70	0.65
140	60	0.57	0.50
160	71	0.44	0.40
180	82	0.31	0.25



SMART WATER MANAGEMENT

With technical tie ups across the globe, Ashirvad strives to bring the latest technology, products and thus solutions into the Indian plumbing market, with more and more satisfied customers each day.



Quality Control Procedures at Ashirvad

Pipes and fittings manufactured at Ashirvad, follow a stringent quality control process before being rolled out into the market, in order to supply a defect free system to its users.

These processes follow the highest specifications of BIS (India), ASTM (USA), DIN, UIPC-I and NSF/ANSI 61. (NSF/ANSI 61 and UIPC-I certification issued by IAPMO - India)

PIPES



Effect on Water

To ensure the quality of water passing through the pipes.



Heat Reversion Test

How much the pipe changes in length when heated in an oven and left to cool. This is a measure of residual stresses left in the pipe during production process.



Hydrostatic Pressure Test at 20°C and 95°C

Short term (Acceptance Test) at 20°C: When subjected to internal hydrostatic pressure the pipe should not burst or crack at the given test pressure for minimum of 1 hour. This pressure must be over 3 times the normal pressure rating.

Long term (Type Test) at 95°C: The pipe should not crack or burst at the given test pressure for a period of 165 hours or 1000 hours.

Thermal Stability: When subjected to this test at 95°C the pipe shall not fail at the prescribed test pressure for a period of 8760 hours (1 year).



Drop Impact Test

Weights are dropped on the pipe to observe for any cracks or failures.



Flattening Test

Samples are compressed so that opposite walls are brought together without the pipe cracking, which is a good measure of correct extrusion techniques during production.



Tensile Strength

The maximum stress that a pipe can withstand while being stretched or pulled.

FITTINGS



Stress Relief Test

To determine the level of internal stress by heating the fitting in an aircirculated oven @ 150°C. There should not be any blisters, weld line splitting or any cracking.

PIPES AND FITTINGS



Burst Pressure Check (All fittings & 2½ - 6 inch pipes only)

Maximum pressure before the fittings burst. This must be over three times the normal pressure rating.



Visual Appearance

To ensure that all pipes and fittings are uniform in colour and free visual effects such as black dots, scratches, burn marks, etc.



Dimensions

To ensure that all pipes and fittings conform to the appropriate standards.



Opacity

To measure the percentage of light flux passing through the wall and to ensure it is below 0.2%.



Vicat Softening Temperature

The temperature at which 1 mm² needle penetrates 1 mm through the wall of the pipe.



Density

Density of pipes and fittings is to be determined.

SYSTEMS



Malfunction Temperature Test at 95°C

An assembly of pipes and fittings should not leak or burst at 10 kg/cm² internal pressure at a temperature of 95°C for 1000 hours.

Handling and Storage

Proper Handling of Pipes



Please check and inspect the pipes on receipt. The pipes should be checked for any forms of transport damage due to shift in loads or improper handling/treatment. Visually examine the ends of pipes for any cracks or damage.



The pipes should be handled with care. The tendency to throw or drop the pipes to the floor should be avoided. Do not drag or push the pipes from a truck bed. Contact of the pipes with any sharp object should be totally avoided.

Storage of Pipes

The pipes should preferably be stored indoors. When this is not possible, please ensure to



Protect the pipes from sun light, to reduce the effect of UV rays.

The pipes should be stored on level ground and on dry surface.

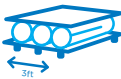

If pipes of same diameter but different classes are being stacked together, place the thicker pipes below. i.e., Stack SDR 11 below SDR 13.5 and stack Sch 80 below Sch 40.

If placing pipes on racks, ensure the spacing between the supports does not exceed 3 feet.

Safe Handling of Solvent Cement

When using solvent cement, primers and cleaners, there are some basic safety measures all users should keep in mind.



After every application of solvent on the pipe / fitting ensure to put the lid back on the solvent cement containers and tighten the lid slightly to avoid evaporation and escape of solvent.



Avoid prolonged breathing of solvent vapours. When pipe and fittings are being joined in enclosed areas, please ensure sufficient ventilation.



Keep the primers, cleaners and solvent cement away from all sources of ignition, heat, sparks and open flame.



Keep containers of solvent cement, primers and cleaners tightly closed except when the product is being used.

Dispose of all rags used with solvents in a proper outdoor waste bin.



Avoid eye and skin contact. In case of eye contact, flush with plenty of water for 15 minutes and call a doctor.

Refer to ASTM F402, Standard Practice for Safe Handling of Solvent cement, Primers, and Cleaners Used for Joining Thermoplastic Pipe and Fittings.

Solvent cement instructions

Recommendations

One Step Solvent cement is recommended for joining of pipes and fittings upto 2" in diameter.

Two Step Solvent cement is recommended for joining of pipes and fittings above 2" in diameter.

Summary

1. The following procedures shall be clearly understood and followed:
 - The joining surfaces must be softened (dissolved) and made semi-fluid.
 - Sufficient solvent cement must be applied to fill the gap between pipe and fitting.
 - Assembly of pipe and fitting must be made while the surfaces are still wet and fluid.
 - Joint strength develops as the solvent cement dries. In the tight part of the joint, the surfaces will tend to fuse together; in the loose part, the One-Step solvent cement will bond to both surfaces.
2. For 1/2" to 2" (12 mm to 50 mm) diameters penetration and dissolving can be achieved by using the One-Step solvent cement itself (see Figure 1). **DO NOT USE A PRIMER WITH ONE-STEP SOLVENT CEMENT.**
3. Sufficient One-Step solvent cement must be applied to fill the gap in the loose part of the joint (see Figure 2). Besides filling the gap, adequate One-Step solvent cement layers will penetrate the surfaces and also remain wet until the joint is assembled.
4. If the One-Step solvent cement coatings on the pipe and fittings are wet and fluid when assembly takes place, they will tend to flow together and become one solvent cement layer. Also, if the solvent cement is wet, the surfaces beneath them will still be soft, and these dissolved surfaces in the tight part of the joint will tend to fuse together (see Figure 3).
5. As the solvent dissipates, the One-Step solvent cement layer and the dissolved surfaces will dry and harden with a corresponding increase in joint strength. Completed joints should not be disturbed until they have cured sufficiently to withstand handling. Joint strength develops as the One-Step solvent cement dries. For information about curing and hardening and the minimum time before the piping system can be pressure tested, refer page 35.

Figure 1: outside of pipe and inside the fitting socket to be softened and penetrated

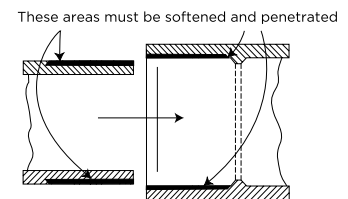

Figure 2: solvent cement coatings of sufficient thickness applied uniformly around pipe and inside fitting socket

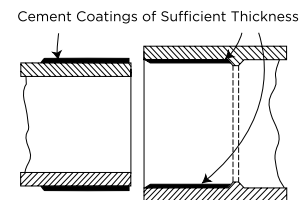
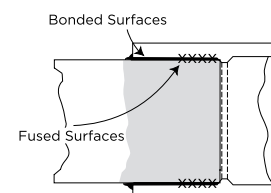

Figure 3: fused and bonded surfaces of joined pipe and fitting



Warning:
Follow all preparation and installation procedures.

Easy and 100% leakproof installation.

Step 1: Cutting

Measure the pipe length accurately and make a visible marking using a felt tip pen. Ensure that the pipe and fittings are size compatible. You can easily cut with a plywood cutting saw/ ratchet cutter or a wheel cutter. Cutting the pipe as squarely as possible (at 90°) provides optimal bonding area within a joint. Inspect pipe ends thoroughly prior to making a joint. If a crack or splintering is noticed cut-off a minimum of 25 mm beyond the visible crack before proceeding.

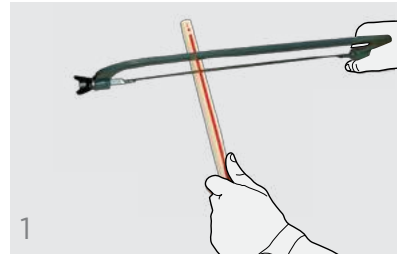

Step 2: Deburring/Beveling

Burrs in and on pipe end can obstruct flow/proper contact between the pipe and socket of the fitting during assembly and should be removed from both in and outside of the pipe. A 15 mm dia half round file/a pen knife or a deburring tool are suitable for this purpose. A slight bevel on the end of the pipe will ease entry of the pipe into the socket of the fitting socket.

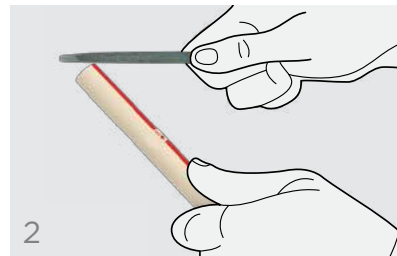

Step 3: Fitting Preparation

Using a clean dry rag, wipe the dirt and moisture from the fitting sockets and pipe end. Dry fit the pipe to ensure total entry into the bottom of the fittings socket and make a visible marking using a felt tip pen.

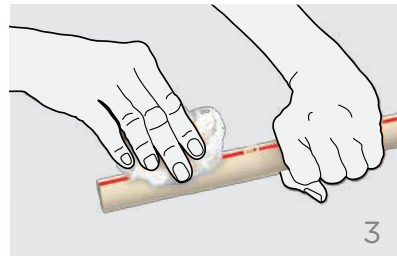

Step 4: One Step Solvent Cement Procedure

Use only Ashirvad FLOWGUARD® PLUS™ CPVC Solvent cement conforming to ASTM F-493 to ensure a perfect solvent weld joint. When making a joint, apply an even coat of solvent cement at the end of the pipe and also inside the fitting socket. Do not use thickened or lumpy solvent cement. It should have a flow consistency like that of syrup or paint.

- For Two Step Solvent Cement Procedure see next page.



Step 5: Assembly

Immediately insert the pipe into the fitting socket, rotate the pipe 1/4 to 1/2 turn while inserting. This motion ensures an even distribution of solvent cement within the joint. **Properly align the fittings as per patented alignment system shown with picture diagram on the right side.** Hold the assembly for 30 seconds to allow the joint to setup and avoid push-out.

A bead of One-Step solvent cement must be formed around the entire socket fitting entrance. With a clean, dry cloth remove the excess solvent cement from the surface of the pipe and fitting.

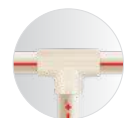
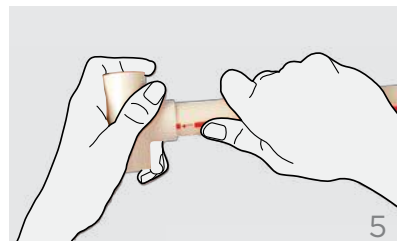

Design Registered only with Ashirvad

Step 4: Two Step Solvent Cement Procedure

- 4a: Apply primer to socket keeping surfaces wet and applicator wet and in motion until the entire joining surface is properly softened. Avoid puddling.
- 4b: Apply to pipe surface in the same manner equal to depth of socket.
- 4c: Apply again to the fitting socket. Avoid puddling.
- 4d: While the primer is still wet and the surfaces are soft, apply a full, even layer of Ashirvad FLOWGUARD® PLUS™ Two-Step solvent cement to the pipe end, equal to the depth of the fitting socket. Like the primer, be aggressive. Remember to apply enough Two-Step solvent cement to fill the gap between the pipe and fitting.
- 4e: Apply a thin layer of Ashirvad FLOWGUARD® PLUS™ Two-Step solvent cement to the inside of the fitting socket. This will prevent puddling of the solvent cement inside of the pipe or fitting. Excessive solvent cement applied to the fitting socket can cause the joint to clog and the wall of the pipe or fitting to weaken due to softening by the trapped solvents.
- 4f: Apply a second full, even layer of Ashirvad FLOWGUARD® PLUS™ Two-Step solvent cement to the pipe end. Excessive solvent cement on the pipe outer diameter (O.D.) can be wiped away after assembly.

Solvent Cement Set & Cure Times

Average initial set schedule for CPVC solvent cement

Temperature Range	Pipe Sizes 1/2"-1 1/4" (15 mm - 32 mm)	Pipe Sizes 1 1/2"-2" (40 mm - 50 mm)	Pipe Sizes 2 1/2"-6" (65 mm - 150 mm)
60° - 100°F / 16° - 38°C	2 minutes	5 minutes	30 minutes
40° - 60°F / 5° - 16°C	5 minutes	10 minutes	2 hours
0° - 40°F / -18° - 5°	10 minutes	15 minutes	12 hours

Note - Initial set schedule is the necessary time to allow before the joint can be carefully handled. In damp or humid weather allow 50% more set time.

Average joint cure schedule for CPVC solvent cement

Relative Humidity 60% or Less	Pipe Sizes 1/2"-1 1/4" (15 mm - 32 mm)		Pipe Sizes 1 1/2"-2" (40 mm - 50 mm)		Pipe Sizes 2 1/2"-6" (65 mm - 150 mm)	
	psi (Bar)		psi (Bar)		psi (Bar)	
Temperature range during assembly and cure periods	up to 160 (up to 11)	160 to 370 (11 to 26)	up to 160 (up to 11)	160 to 315 (11 to 22)	up to 160 (up to 11)	160 to 315 (11 to 22)
60° - 100°F / 16° - 38°C	15 minutes	6 hours	30 minutes	12 hours	1 - 1/2 hours	24 hours
40° - 60°F / 5° - 16°C	20 minutes	12 hours	45 minutes	24 hours	4 hours	48 hours
0° - 40°F / -18° - 5°C	30 minutes	48 hours	1 hour	96 hours	72 hours	8 days

Note - Joint cure schedule is the necessary time to allow before pressurizing system. In damp or humid weather allow 50% more cure time.



CAUTION: These figures are estimates based on testing done under laboratory conditions. Although this information is widely published across the industry, these charts should be used as a general reference only. Field working conditions can vary significantly and will increase set and cure times.

Pressuring Solvent Cement Joints

Care must be taken to allow solvent cemented joints to adequately cure and develop full strength. A number of factors will impact the required cure time before joints can be pressurised. These factors include:

- a. On-site temperature and humidity
- b. Pipe diameter (larger diameter joints require more time to cure)
- c. Internal operating pressure
- d. Internal operating temperature

In general, the cure times will allow cold water lines to be pressurised to the cited levels shown.

Based on field experience, hot water lines may require an additional 50% longer cure time or more, before operating at full hot water service conditions. Contractors performing repairs, modifications or maintenance must allow joints to properly cure before pressurising the system with hot water. Reduced operating pressures and temperatures may allow the system to return to service earlier.

Hot Weather Solvent Cement Application - Above 86°F (30°C)

1. Store solvent cement in a cool or shaded area prior to use.
2. If possible store pipe and fittings in a shaded area prior to solvent cement jointing.
3. Cool surfaces to be joined with a clean, damp rag. Be sure the surface is dry prior to application of solvent cement.
4. Try applying solvent cement joints in the cooler morning hours.
5. Make sure both surfaces to be joined are still wet with solvent cement when joining them together.
6. Vigorously stir or shake the solvent cement before use.
7. System anchoring and final connections should be made during the cooler hours of the day to account for expansion and contraction.

System Acceptance (Hydrostatic Pressure) Test

Once an installation is completed and cured as per these recommendations, the system should be hydrostatically pressure tested at 10 bar for one hour. When pressure testing, the system should be filled with water and all air removed from the farthest and highest points in the run.

If a leak is found, the joint must be cut out and discarded and a new section should be installed using couplings.



Danger: Pressure testing with compressed air is dangerous and can result in injury or death. do not use air to test Ashirvad FLOWGUARD®PLUS™ CPVC pipe, fittings and accessories.

Installation Warning

1. Dry fit all joints prior to application of solvent cement to confirm proper interference fit.
2. Discard fitting joints without proper interference fit.
3. DO NOT apply solvent cement joints that are too loose or too tight.
4. Always use proper bevelling tools to prepare pipe ends before applying cement.
5. DO NOT apply solvent cement on joints without first bevelling pipe ends.
6. Use only One-Step solvent cement to connect 1/2" to 2" (12 mm to 50 mm) pipe, fittings and accessories.
7. DO NOT use primer with One-Step solvent cement.
8. DO NOT use other solvent cement to connect Ashirvad FLOWGUARD® PLUS™ CPVC pipe, fittings and accessories.
9. Follow all solvent cement application instructions provided with this product.
10. Ashirvad fully endorses safety and protective measures recommended by government agencies when installing FLOWGUARD® PLUS™ CPVC pipe, other plastic pipe or metal pipe.
11. Always provide proper ventilation when applying primers and solvent cement.
12. Avoid unnecessary skin or eye contact with primers and solvent cement.
13. Wash immediately if contact occurs to avoid prolonged exposure.
14. Follow all manufacturer-recommended precautions when cutting or sawing pipe or when using any flame, heat or power tools.
15. After hydrostatic testing, thoroughly flush the system for at least 10 minutes to remove residual trace amounts of solvent cement.
16. Avoid open flames or soldering around solvent cement applied joints.



Never test Ashirvad FLOWGUARD® PLUS™ CPVC pipe, fittings or accessories with compressed air. Serious injury or death can occur.



Ashirvad FLOWGUARD® PLUS™ CPVC systems for use with water and compatible fluids only. They are not to be used for compressed air.

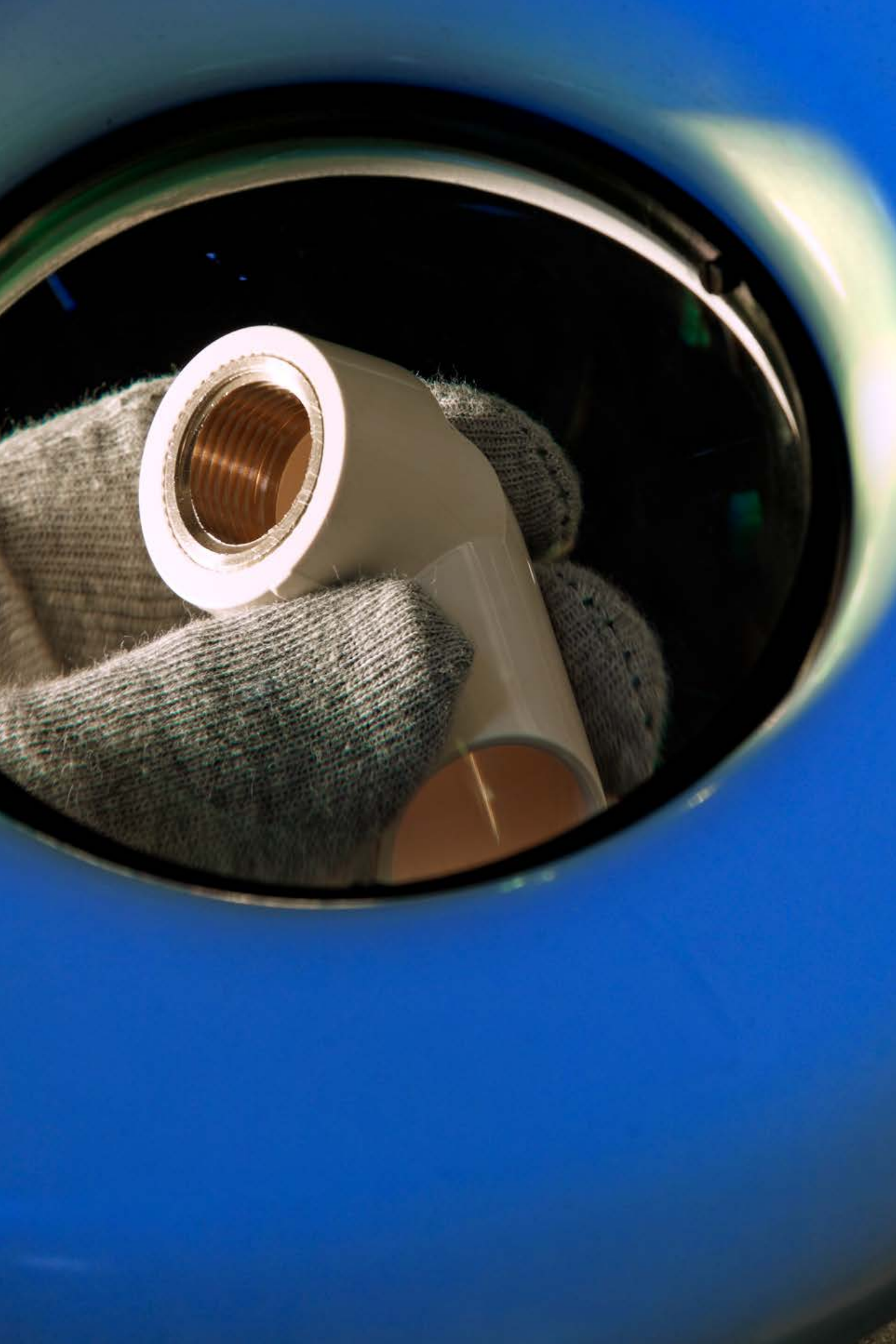



Fittings - Dimensions

MALE ADAPTER PLASTIC THREADED - MAPT

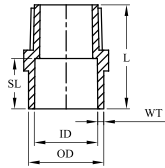

SIZE	ID	OD	WT	SL	L
1/2"	16.08	21.26	2.59	12.70	32.0
3/4"	22.45	27.63	2.59	17.78	42.3
1"	28.83	33.56	2.59	22.86	48.0
1 1/4"	35.20	41.56	3.18	27.94	54.5
1 1/2"	41.66	49.18	3.76	33.02	61.5
2"	54.38	64.18	4.90	43.18	75.0

Reducing Male Adapter Plastic Threaded - MAPT

3/4 x 1/2"	22.45	27.63	2.59	17.78	41.6
1 x 3/4"	28.83	33.56	2.59	22.86	44.0

CONVERTER BUSHING

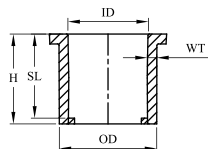

SIZE	ID	OD	WT	SL	H
1/2"	16.08	21.26	2.59	12.70	24.30
3/4"	22.45	27.63	2.59	17.78	28.75
1"	28.83	33.56	2.59	22.86	32.00
1 1/4"	35.20	41.56	3.18	27.94	35.10
1 1/2"	41.66	49.18	3.76	33.02	38.20
2"	54.38	64.18	4.90	43.18	46.50

TANK NIPPLE (WITH ONE SIDE PIPE FITMENT)

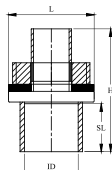

SIZE	ID	SL	L	H
3/4"	22.45	17.78	45.60	75
1"	28.83	22.86	56.30	86

TANK NIPPLE

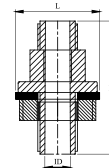

SIZE	ID	L	H
1/2"	16.08	40.9	68.8
3/4"	22.45	45.6	75.0
1"	28.83	56.3	86.0
1 1/4"	35.20	65.0	94.0
1 1/2"	41.66	71.5	102.0
2"	54.38	82.0	103.3
2 1/2"	73.38	104.0	352.0
3"	89.39	130.0	352.0
4"	96.00	148.0	400.0

UNION

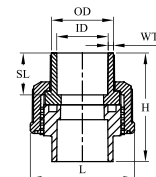

SIZE	ID	OD	WT	SL	L	H
1/2"	16.08	21.26	2.59	12.70	39.2	36.8
3/4"	22.45	27.63	2.59	17.78	53.0	47.0
1"	28.83	33.56	2.59	22.86	52.0	57.4
1 1/4"	35.20	41.56	3.18	27.94	60.0	70.0
1 1/2"	41.66	49.18	3.76	33.02	71.5	86.0
2"	54.38	64.18	4.90	43.18	90.0	108.0

BRASS UNION - MABT

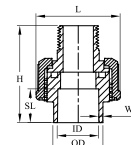

SIZE	ID	OD	WT	SL	L	H
3/4"	22.45	27.63	2.59	17.78	53	57.25
1"	28.83	33.56	2.59	22.86	65	66.00

BRASS UNION - FABT

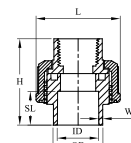

SIZE	ID	OD	WT	SL	L	H
3/4"	22.45	27.63	2.59	17.78	53	55.9
1"	28.83	33.56	2.59	22.86	65	55.62

TEE

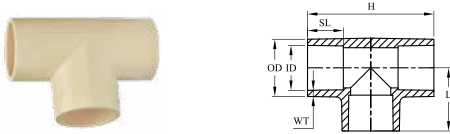

SIZE	ID	OD	WT	SL	L	H
1/2"	16.08	21.26	2.59	12.70	22.6	45.0
3/4"	22.45	27.63	2.59	17.78	30.9	62.5
1"	28.83	33.56	2.59	22.86	39.1	78.0
1 1/4"	35.20	41.56	3.18	27.94	47.4	94.5
1 1/2"	41.66	49.18	3.76	33.02	55.7	111.0
2"	54.38	64.18	4.90	43.18	72.2	143.5

COUPLER

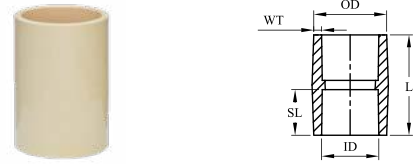

SIZE	ID	OD	WT	SL	L
1/2"	16.08	21.26	2.59	12.70	28
3/4"	22.45	27.63	2.59	17.78	38
1"	28.83	33.56	2.59	22.86	48
1 1/4"	35.20	41.56	3.18	27.94	60
1 1/2"	41.66	49.18	3.76	33.02	70
2"	54.38	64.18	4.90	43.18	90

END CAP

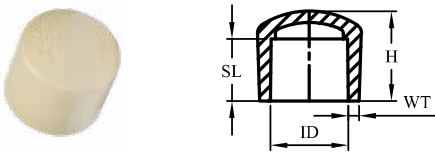

SIZE	ID	WT	SL	H
1/2"	16.08	2.59	12.70	18.5
3/4"	22.45	2.59	17.78	25.8
1"	28.83	2.59	22.86	32.5
1 1/4"	35.20	3.18	27.94	41.0
1 1/2"	41.66	3.76	33.02	44.0
2"	54.38	4.90	43.18	56.0

FEMALE ADAPTER PLASTIC THREADED - FAPT

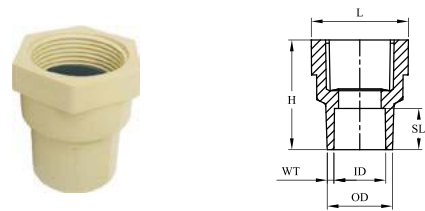

SIZE	ID	OD	WT	SL	L	H
1/2"	16.08	21.26	2.59	12.70	34.0	26.7
3/4"	22.45	27.63	2.59	17.78	42.0	32.4
1"	28.83	33.56	2.59	22.86	49.0	40.0
1 1/4"	35.20	41.56	3.18	27.94	61.5	51.0
1 1/2"	41.66	49.18	3.76	33.02	67.0	89.5
2"	54.38	64.18	4.90	43.18	81.0	72.5

CROSS TEE

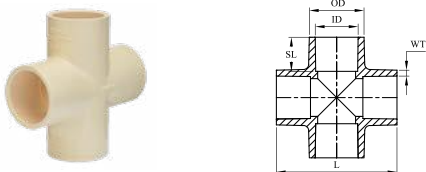

SIZE	ID	OD	WT	SL	L
1/2"	16.08	21.26	2.59	12.70	18.5
3/4"	22.45	27.63	2.59	17.78	25.8
1"	28.83	33.56	2.59	22.86	32.5

BALL VALVE

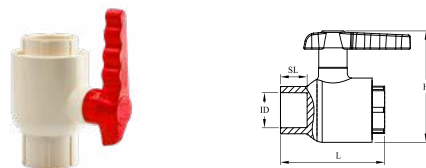

SIZE	ID	SL	L	H
1/2"	16.08	12.70	60.4	63.5
3/4"	22.45	17.78	78.3	75.1
1"	28.83	22.86	98.6	93.3
1 1/4"	35.20	27.94	114.0	108.4
1 1/2"	41.66	33.02	125.0	129.0
2"	54.38	43.18	161.0	160.0

TEE HOLDER



SIZE	ID	WT	L	H
1/2 x 1/2 x 1/2"	33.34	1.50	63.7	75.7
3/4 x 3/4 x 1/2"	33.34	1.60	64.7	90.0
1 x 1 x 1/2"	28.83	2.59	70.2	110.5

**BALL VALVE WITH BRASS THREADED
(ONE SIDE)**

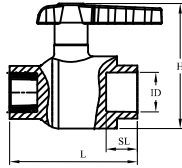

SIZE	ID	SL	L	H
3/4"	22.45	17.78	78.3	75.1
1"	28.83	22.86	98.6	93.3

**BALL VALVE WITH BRASS THREADED
(TWO SIDE)**

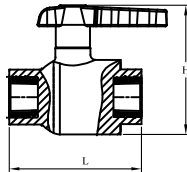

SIZE	L	H
3/4"	78.3	75.1
1"	98.6	93.3

BALL VALVE - HANDLE

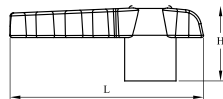

SIZE	L	H
1/2"	74.4	19.5
3/4"	84.3	21.5
1"	108.0	30.0
1 1/4"	116.0	34.0
1 1/2"	130.0	36.0
2"	158.0	50.0

ELBOW 90°

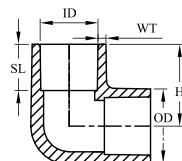

SIZE	ID	OD	WT	SL	H
1/2"	16.08	21.26	2.59	12.70	33
3/4"	22.45	27.63	2.59	17.78	44

1"	28.83	33.56	2.59	22.86	56
1 1/4"	35.20	41.56	3.18	27.94	70
1 1/2"	41.66	49.18	3.76	33.02	80
2"	54.38	64.18	4.90	43.18	105

MALE ADAPTER BRASS THREADED - MABT

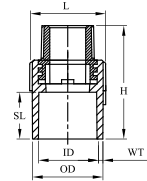

SIZE	ID	OD	WT	SL	L	H
1/2"	16.08	21.26	2.59	12.7	26.7	50.40
3/4"	22.45	27.63	2.59	17.78	30.0	56.23
1"	28.83	33.56	2.59	22.86	37.7	73.20
1 1/4"	35.20	41.56	3.18	27.94	50.0	80.40
1 1/2"	41.66	49.18	3.76	33.02	56.8	87.40
2"	54.38	64.18	4.90	43.18	69.5	102.50

**REDUCING MALE ADAPTER BRASS THREADED
- MABT**

3/4 x 1/2"	16.08	21.26	2.59	17.78	26.8	55.0
1 x 1/2"	22.45	27.63	2.59	22.86	36.8	55.7
1 x 3/4"	28.83	33.56	2.59	22.86	37.0	55.0

BRASS ELBOW - MABT

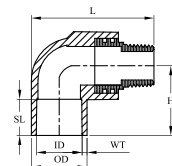

SIZE	ID	OD	WT	SL	L	H
3/4 x 1/2"	22.45	27.63	2.59	17.78	60.3	34.3

BRASS ELBOW - LONG

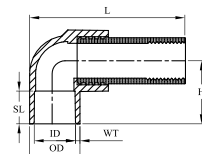

SIZE	ID	OD	WT	SL	L	H
3/4 x 1/2"	22.45	27.63	2.59	17.78	84.3	34.3

REDUCER COUPLER

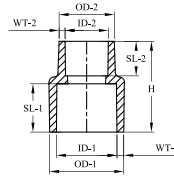

SIZE	ID-1	OD-1	WT-1	SL-1	ID-2	OD-2	WT-2	SL-2	H
3/4 x 1/2"	22.45	27.63	2.59	17.78	16.08	21.26	2.59	12.70	34.0
1 x 1/2"	28.83	33.56	2.59	22.86	16.08	21.26	2.59	12.70	40.0
1 x 3/4"	28.83	33.56	2.59	22.86	22.45	27.63	2.59	17.78	44.0
1 1/4 x 1/2"	35.20	41.56	3.18	27.94	16.08	21.26	2.59	12.70	51.5
1 1/4 x 3/4"	35.20	41.56	3.18	27.94	22.45	27.63	2.59	17.78	61.5
1 1/4 x 1"	35.20	41.56	3.18	27.94	28.83	33.56	2.59	22.86	44.5
1 1/2 x 1/2"	41.66	49.18	3.76	33.02	16.08	21.26	2.59	12.70	50.0
1 1/2 x 3/4"	41.66	49.18	3.76	33.02	22.45	27.63	2.59	17.78	56.0
1 1/2 x 1"	41.66	49.18	3.76	33.02	28.83	33.56	2.59	22.86	67.0
1 1/2 x 1 1/4"	41.66	49.18	3.76	33.02	35.20	41.56	3.18	27.94	55.0
2 x 1/2"	54.38	64.18	4.90	43.18	16.08	21.26	2.59	12.70	62.0
2 x 3/4"	54.38	64.18	4.90	43.18	22.45	27.63	2.59	17.78	71.5
2 x 1"	54.38	64.18	4.90	43.18	28.83	33.56	2.59	22.86	69.0
2 x 1 1/4"	54.38	64.18	4.90	43.18	35.20	41.56	3.18	27.94	76.0
2 x 1 1/2"	54.38	64.18	4.90	43.18	41.66	49.18	3.76	33.02	81.5
2 1/2 x 2"	73.38	87.4	7.01	44.45	54.38	64.18	4.9	43.18	103.96
3 x 2 1/2"	89.31	107.55	7.62	47.63	73.38	87.4	7.01	44.45	107.1
2 1/2 x 2" (SCH 40)	73.38	83.68	5.15	44.45	54.38	64.18	4.9	43.18	103.96
3 x 2 1/2" (SCH 40)	89.31	100.29	5.49	47.63	73.38	83.68	5.15	44.45	107.1

REDUCER TEE

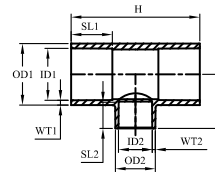

SIZE	ID-1	OD-1	WT-1	SL-1	ID-2	OD-2	WT-2	SL-2	L	H
1/2 x 1/2 x 3/4"	16.08	21.26	2.59	12.70	22.45	27.63	2.59	17.78	62.5	44.0
3/4 x 1/2 x 3/4"	22.45	27.63	2.59	17.78	16.08	21.26	2.59	12.70	62.5	44.0
1/2 x 3/4 x 1/2"	16.08	21.26	2.59	12.70	22.45	27.63	2.59	17.78	62.5	44.0
3/4 x 3/4 x 1/2"	22.45	27.63	2.59	17.78	16.08	21.26	2.59	12.70	40.0	62.5
1 x 1 x 1/2"	28.83	33.56	2.59	22.86	16.08	21.26	2.59	12.70	46.4	78.0
1 x 1 x 3/4"	28.83	33.56	2.59	22.86	22.45	27.63	2.59	17.78	51.0	78.0
1 1/4 x 1 1/4 x 1/2"	35.20	41.56	3.18	27.94	16.08	21.26	2.59	12.70	53.0	94.5
1 1/4 x 1 1/4 x 3/4"	35.20	41.56	3.18	27.94	22.45	27.63	2.59	17.78	58.0	94.5
1 1/4 x 1 1/4 x 1"	35.20	41.56	3.18	27.94	28.83	33.56	2.59	22.86	62.0	94.5
1 1/2 x 1 1/2 x 1/2"	41.66	49.18	3.76	33.02	16.08	21.26	2.59	12.70	62.0	111.0
1 1/2 x 1 1/2 x 3/4"	41.66	49.18	3.76	33.02	22.45	27.63	2.59	17.78	66.0	111.0
1 1/2 x 1 1/2 x 1"	41.66	49.18	3.76	33.02	28.83	33.56	2.59	22.86	70.0	111.0
1 1/2 x 1 1/2 x 1 1/4"	41.66	49.18	3.76	33.02	35.20	41.56	3.18	27.94	75.0	111.0
2 x 2 x 1/2"	54.38	64.18	4.90	43.18	16.08	21.26	2.59	12.70	72.3	143.5
2 x 2 x 3/4"	54.38	64.18	4.90	43.18	22.45	27.63	2.59	17.78	78.6	143.5
2 x 2 x 1"	54.38	64.18	4.90	43.18	28.83	33.56	2.59	22.86	82.0	143.5
2 x 2 x 1 1/4"	54.38	64.18	4.90	43.18	35.20	41.56	3.18	27.94	87.0	143.5
2 x 2 x 1 1/2"	54.38	64.18	4.90	43.18	41.66	49.18	3.76	33.02	93.0	143.5
2 1/2 x 2 1/2 x 2"	73.38	83.68	5.15	44.45	54.38	64.18	4.9	43.18	82.2	160.9
3 x 3 x 2"	89.31	100.29	5.49	47.63	55.38	65.18	4.9	43.18	95.45	181.11
3 x 3 x 2 1/2"	90.31	104.55	7.62	47.63	73.38	87.4	7.01	44.45	95.45	181.1

REDUCER ELBOW 90°

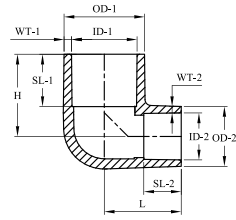

IN	ID-1	OD-1	WT-1	SL-1	ID-2	OD-2	WT-2	SL-2	L	H
3/4 x 1/2"	22.45	27.63	2.59	17.78	16.08	21.26	2.59	12.70	26.3	28.1
1 x 1/2"	28.83	33.56	2.59	22.86	16.08	21.26	2.59	12.70	33.1	39.4
1 x 3/4"	28.83	33.56	2.59	22.86	22.45	27.63	2.59	17.78	34.0	40.2

BRASS ELBOW WITH CLAMP

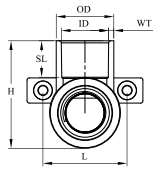

1 1/4"	35.20	41.56	3.18	27.94	56	69.5
1 1/2"	41.66	49.18	3.76	33.02	65	80.0
2"	54.38	64.18	4.90	43.18	88	105.0

SIZE ID OD WT SL L H

3/4 x 1/2"	22.45	27.63	2.59	17.78	40	51
------------	-------	-------	------	-------	----	----

EXTENSION NIPPLE

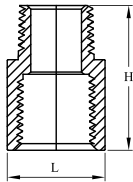

SIZE L H

1/2 x 1"	27.0	32.0
1/2 x 1 1/2"	27.0	40.0
1/2 x 2"	27.0	52.0
1/2 x 2 1/2"	27.0	
1/2 x 3"	27.0	

ELBOW 45°

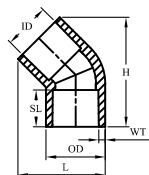

SIZE ID OD WT SL L H

1/2"	16.08	21.26	2.59	12.70	27	33.0
3/4"	22.45	27.63	2.59	17.78	38	44.0
1"	28.83	33.56	2.59	22.86	50	56.0

ELBOW 90° (BRASS)

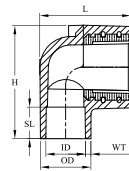

SIZE ID OD WT SL L H

1/2 x 1/2"	16.080	21.260	2.59	12.700	38.00	46.0
3/4 x 1/2"	22.450	27.630	2.59	17.780	43.00	51.0
3/4 x 3/4"	22.450	27.630	2.59	17.780	41.20	54.0
1 x 1/2"	28.830	33.560	2.59	22.860	52.60	55.6
1 x 3/4"	28.830	33.560	2.59	22.860	54.85	57.0
1 x 1"	32.707	37.887	2.59	26.416	58.10	61.9
1 1/4 x 1/2"	35.200	41.560	3.18	27.940	55.13	64.6
1 1/4 x 3/4"	36.200	42.560	3.18	27.940	55.00	68.8
1 1/4 x 1 1/4"	37.200	43.560	3.18	27.940	63.70	75.5

3 IN 1 MIXER ALL TOP (6")

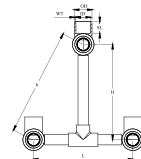

SIZE ID OD WT SL L H h

3/4 x 1/2" (FTA)	22.45	27.63	2.59	17.78	152.4	146.4	165.1
3/4 x 1/2" (MTA)	22.45	27.63	2.59	17.78	152.4	146.4	165.1
1 x 1/2"	28.83	33.56	2.59	22.86	152.4	146.4	165.1

3 IN 1 MIXER TOP AND BOTTOM (6")



SIZE	ID	OD	WT	SL	L	H	h
3/4 x 1/2" (FTA)	22.45	27.63	2.59	17.78	152.4	146.4	165.1
3/4 x 1/2" (MTA)	22.45	27.63	2.59	17.78	152.4	146.4	165.1
1 x 1/2"	28.83	33.56	2.59	22.86	152.4	146.4	165.1

3 IN 1 MIXER TOP AND SIDE (6")



SIZE	ID	OD	WT	SL	L	H	h
3/4 x 1/2" (FTA)	22.45	27.63	2.59	17.78	152.4	146.4	165.1
3/4 x 1/2" (MTA)	22.45	27.63	2.59	17.78	152.4	146.4	165.1
1 x 1/2"	28.83	33.56	2.59	22.86	152.4	146.4	165.1

3 IN 1 MIXER HOT UP AND COLD DOWN (6")

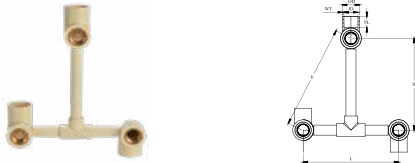

SIZE	ID	OD	WT	SL	L	H	h
3/4 x 1/2"	22.45	27.63	2.59	17.78	152.4	146.4	165.1
1 x 1/2"	28.83	33.56	2.59	22.86	152.4	146.4	165.1

3 IN 1 MIXER ALL TOP (7")



SIZE	ID	OD	WT	SL	L	H	h
3/4 x 1/2"	22.45	27.63	2.59	17.78	177.8	146.4	171.3
1 x 1/2"	28.83	33.56	2.59	22.86	177.8	146.4	171.3

3 IN 1 MIXER TOP AND BOTTOM (7")



SIZE	ID	OD	WT	SL	L	H	h
3/4 x 1/2"	22.45	27.63	2.59	17.78	177.8	146.4	171.3
1 x 1/2"	28.83	33.56	2.59	22.86	177.8	146.4	171.3

3 IN 1 MIXER TOP AND SIDE (7")



SIZE	ID	OD	WT	SL	L	H	h
3/4 x 1/2"	22.45	27.63	2.59	17.78	177.8	146.4	171.3
1 x 1/2"	28.83	33.56	2.59	22.86	177.8	146.4	171.3

3 IN 1 MIXER HOT UP AND COLD DOWN (7")



SIZE	ID	OD	WT	SL	L	H	h
3/4 x 1/2"	22.45	27.63	2.59	17.78	177.8	146.4	171.3
1 x 1/2"	28.83	33.56	2.59	22.86	177.8	146.4	171.3

KITCHEN MIXER ADAPTOR

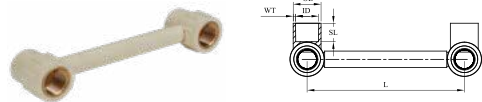

SIZE	ID	OD	WT	SL	L
3/4 x 1/2"	22.45	27.63	2.59	17.78	152.4

FEMALE ADAPTER BRASS THREADED - FABT

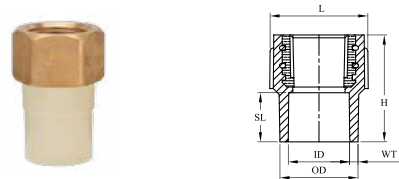

SIZE	ID	OD	WT	SL	L	H
1/2"	16.08	21.26	2.59	12.70	26.6	44.3
3/4"	22.45	27.63	2.59	17.78	33.2	53.2
1"	28.83	33.56	2.59	22.86	41.4	67.0
1 1/4"	35.20	41.56	3.18	27.94	50.3	78.0
1 1/2"	41.66	49.18	3.76	33.02	56.8	82.7
2"	54.38	64.18	4.90	43.18	69.4	93.6

THREADED END PLUG



SIZE	L	H
1/2"	30.34	77.1
3/4"	35.25	76.3

REDUCING FEMALE ADAPTER BRASS THREADED

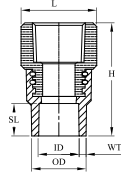

SIZE	ID	OD	WT	SL	L	H
3/4 x 1/2"	16.08	21.26	2.59	17.78	33.1	38.8
1 x 1/2"	22.45	27.63	2.59	22.86	37.0	44.2
1 x 3/4"	28.83	33.56	2.59	22.86	37.2	44.3

ELBOW HOLDER

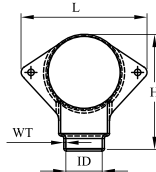

SIZE	ID	WT	L	H
1/2 x 1/2"	33.34	1.5	65.7	61.5
3/4 x 1/2"	33.34	1.6	65.6	65.5

TEE (BRASS)

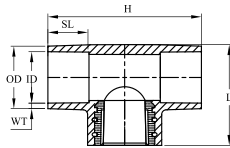

SIZE	ID	OD	WT	SL	L	H
1/2 x 1/2 x 1/2"	16.08	21.26	2.59	12.70	37.0	51.30
3/4 x 3/4 x 1/2"	22.45	27.63	2.59	17.78	45.1	68.00
3/4 x 3/4 x 3/4"	22.45	27.63	2.59	17.78	45.5	69.25
1 x 1 x 1/2"	28.83	33.56	2.59	22.86	50.3	78.00
1 x 1 x 3/4"	28.83	33.56	2.59	22.86	53.0	75.10
1 x 1 x 1"	28.83	33.56	2.59	22.86	58.6	77.80
1 1/4 x 1 1/4 x 1/2"	35.20	41.56	3.18	27.94	54.1	85.90

BRASS TEE - MABT

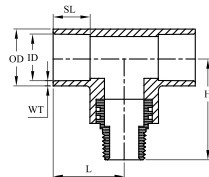

SIZE	ID	OD	WT	SL	L	H
3/4 x 3/4 x 1/2"	22.45	27.63	2.59	17.78	34.1	49.2

EXPANSION LOOP

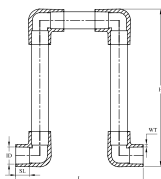

SIZE	ID	WT	SL	H	L
1/2"	16.08	1.73	12.70	190	95
3/4"	22.45	2.03	17.78	225	112
1"	28.83	2.59	22.86	255	128
1 1/4"	35.20	3.18	27.94	282	141
1 1/2"	41.66	3.76	33.02	306	153
2"	24.38	4.90	43.18	350	175

PLASTIC CLAMP

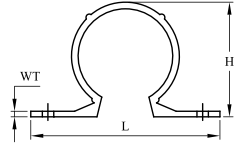

SIZE	WT	L	H
1/2"	2.2	40.0	23.46
3/4"	2.4	62.5	30.50
1"	2.6	71.0	38.40
1 1/4"	2.8	79.5	46.75
1 1/2"	3.0	87.0	54.14
2"	3.0	100.5	68.50

BUSHING

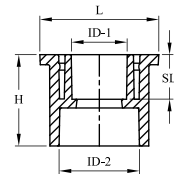

SIZE	ID-1	ID-2	SL	L	H
3/4 x 1/2"	22.45	16.08	12.70	22.45	18.00
1 x 1/2"	28.83	16.08	12.70	34.0	26.35
1 x 3/4"	28.83	22.45	17.78	34.0	26.35
1 1/4 x 1/2"	35.20	16.08	12.70	41.5	31.10
1 1/4 x 3/4"	35.20	22.45	17.78	41.5	31.10
1 1/2 x 1/2"	41.66	16.08	12.70	49.3	36.30
1 1/2 x 3/4"	41.66	22.45	17.78	49.3	36.30
1 1/2 x 1"	41.66	28.83	22.86	49.3	36.30
1 1/2 x 1 1/4"	41.66	35.20	27.94	49.3	36.30
2 x 1/2"	54.38	16.08	12.70	64.0	46.00
2 x 3/4"	54.38	22.45	17.78	64.0	45.00
2 x 1"	54.38	28.83	22.86	64.0	45.00
2 x 1 1/4"	54.38	35.20	27.94	64.0	45.00
2 x 1 1/2"	54.38	41.66	33.02	64.0	45.00

POWDER COATED METAL CLAMP

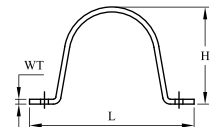

SIZE	WT	L	H
1/2"	1.2	60.0	22
3/4"	1.2	65.0	27
1"	1.2	71.0	34



The following notation (symbols) shall apply in this reference manual.

L - Length
W - Width
H - Height

T - Thickness
U - No. of holes
SL - Socket Length

ID - Inner Diameter
OD - Outer Diameter
WT - Wall Thickness

by allaxis

1¼"	1.2	80.5	42
1½"	1.2	88.0	49
2"	1.2	104.0	60

SWEEP BEND - SOCKET AT BOTH SIDES



SIZE	ID	OD	WT	SL	H
¾"	22.45	27.63	2.59	17.78	67.3
1"	28.83	33.56	2.59	22.86	102
1¼"	35.2	41.56	3.18	27.94	103.1

SS CLAMP

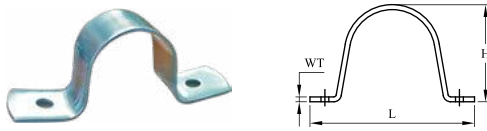

SIZE	WT	L	H
½"	1.2	56.03	16.40
¾"	1.2	66.88	23.43
1"	1.2	74.32	30.39
1¼"	1.2	78.08	33.38
1½"	1.2	88.40	41.95
2"	1.2	99.20	57.90

STEP OVER BEND

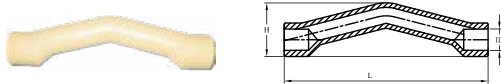

SIZE	ID	L	h	H
½"	16.08	186.1	27.5	37.6
¾"	22.45	229.2	33.8	50.6
1"	28.83	295.8	43.7	64.1
1¼"	32.20	367.2	54.3	78.2
1½"	41.66	360	61.5	85
2"	54.38	500	77.9	110

ELBOW 90° (SCH 80)

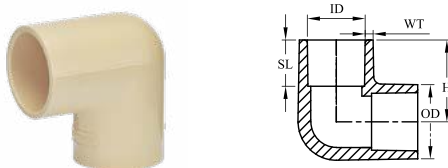

SIZE	ID	OD	WT	SL	H
2½"	73.38	87.40	7.01	44.45	132
3"	89.31	104.55	7.62	47.63	150
4"	114.76	131.92	8.58	57.15	182

ELBOW 90° (SCH 40)

2½"	73.38	83.68	5.15	44.45	129
3"	89.31	100.29	5.49	47.63	148
4"	114.76	126.80	6.02	57.15	182
6"	168.10	182.32	7.11	77.80	250

TEE 90° (SCH 80)

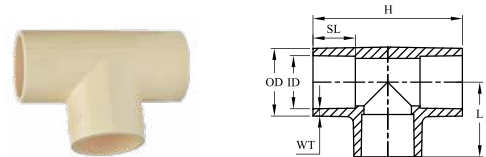

SIZE	ID	OD	WT	SL	L	H
2½"	73.38	87.40	7.01	44.45	130.0	174
3"	89.31	104.55	7.62	47.63	140.0	200
4"	114.76	131.92	8.58	57.15	188.0	245

TEE 90° (SCH 40)

2½"	73.38	83.68	5.15	44.45	129.0	174
3"	89.31	100.29	5.49	47.63	140.0	200
4"	114.76	126.80	6.02	57.15	186.0	245
6"	168.10	182.32	7.11	250.00	77.8	330

COUPLER (SCH 80)

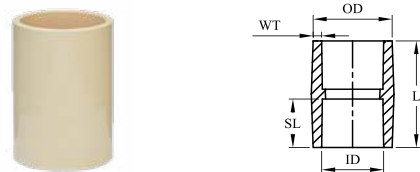

SIZE	ID	OD	WT	SL	L
2½"	73.38	87.40	7.01	44.45	96.5
3"	89.31	104.55	7.62	47.63	102.0
4"	114.76	131.92	8.58	57.15	121.0

COUPLER (SCH 40)

2½"	73.38	83.68	5.15	44.45	96.5
3"	89.31	100.29	5.49	47.63	102.0
4"	114.76	126.80	6.02	57.15	121.0
6"	168.10	182.32	7.11	77.80	160.0

BUSHINGS (SCH 40 AND 80)

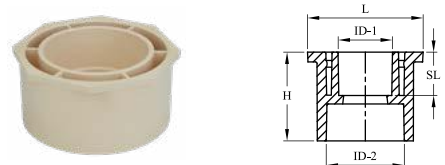

SIZE	ID-1	ID-2	SL	L	H
2½ x 2"	73.38	54.38	43.18	79.7	56.3
3 x 2"	89.31	54.38	43.18	98.0	56.3
3 x 2½"	89.31	73.38	44.45	98.1	56.3
4 x 2"	114.76	54.38	43.18	123.0	66.0
4 x 2½"	114.76	73.38	44.45	123.0	66.0
4 x 3"	114.76	89.31	47.62	123.0	66.0
6 x 3"	168.10	89.31	47.62	170.0	85.0
6 x 4"	168.10	114.76	57.15	170.0	85.0

END CAP (SCH 80)

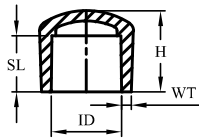

SIZE	ID	WT	SL	H
2½"	73.38	5.15	44.45	60
3"	89.31	5.49	47.63	66
4"	114.76	6.02	57.15	80

END CAP (SCH 40)

6"	168.10	7.11	77.80	105
----	--------	------	-------	-----

FLANGE - END CAP OPEN (WITH RUBBER GASKET)

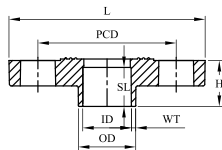

SIZE	ID	OD	WT	SL	L	H	PCD
1"	28.83	33.56	2.59	22.86	115	27.0	85.58
1¼"	35.20	41.56	3.18	27.94	126	32.0	91.53
1½"	41.66	49.18	3.76	33.02	135	39.0	99.2
2"	54.38	64.18	4.90	43.18	160	49.0	120.6
2½"	73.38	83.68	5.15	44.45	176	50.7	134.06
3"	89.31	100.29	5.49	47.63	188	55.3	148.0
4"	114.76	126.80	6.02	57.15	225	68.0	189.0
6"	168.10	182.32	7.11	77.8	278	87.0	241.3

FLANGE - END CAP CLOSED (WITH RUBBER GASKET)

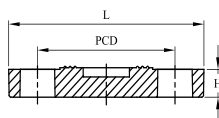

SIZE	L	H	PCD
1"	115	15	85.58
1¼"	126	16	91.53
1½"	135	18	99.2

2"	160	18	120.6
2½"	176	23	134.06
3"	188	23	148.0
4"	225	28	189.0
6"	278	28	241.3

SHORT BEND

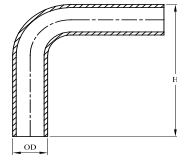

SIZE	OD	H
½"	15.9	125
¾"	22.2	130
1"	28.6	140
1¼"	34.9	150
1½"	41.3	160
2"	54.0	185
2½"	73.0	370
3"	89.0	420
4"	114.25	510

FEMALE ADAPTER PLASTIC THREADED - FAPT (SCH 80)

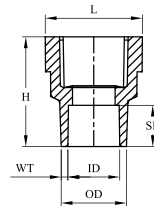

SIZE	ID	OD	WT	SL	L	H
2½"	73.38	87.40	7.01	44.45	87.5	77.5
3"	89.31	104.55	7.62	47.63	104.0	87.0
4"	114.76	131.92	8.58	57.15	128.0	105.0

MALE ADAPTER PLASTIC THREADED - MAPT (SCH 80)

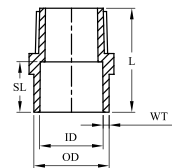

SIZE	ID	OD	WT	SL	L
2½"	73.38	87.40	7.01	44.45	81.5
3"	89.31	104.55	7.62	47.63	87.5
4"	114.76	131.92	8.58	57.15	108.0

ELBOW 45° (SCH 80)

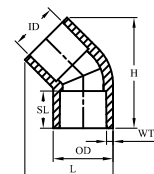

SIZE	ID	OD	WT	SL	L	H
2½"	73.38	87.40	7.01	44.45	130	168

3	89.31	104.55	7.62	47.63	126	188
4	114.76	131.92	8.58	57.15	145	235

RUBBER WASHER - UNION O-RING

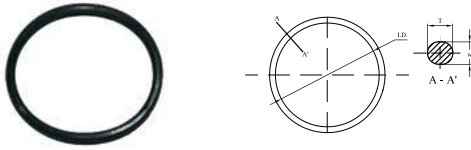

SIZE	ID	W	T
1/2"	19.9	2.5	3.0
3/4"	22.0	3.4	3.7
1"	30.0	3.9	4.3
1 1/4"	35.7	2.8	2.8
1 1/2"	42.0	2.8	3.3
2"	54.9	3.8	3.8

FAPT WASHER

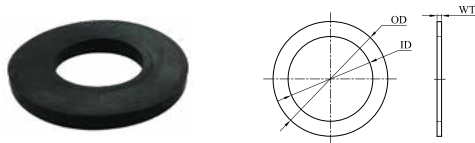

SIZE	ID	OD	WT
1/2"	15.3	19.0	1.8
3/4"	19.2	24.4	2.5
1"	24.1	30.7	3.3
1 1/4"	32.0	39.9	4.0
1 1/2"	36.8	45.7	4.5
2"	46.5	57.6	5.4

TANK NIPPLE WASHER

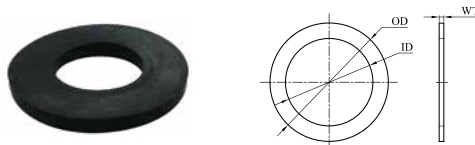

SIZE	ID	OD	WT
1/2"	20.0	40.9	3
3/4"	25.5	45.6	3
1"	32.4	55.5	3
1 1/4"	41.3	65.0	3
1 1/2"	47.3	71.0	3
2"	58.7	83.0	3

LONG CONCEALED VALVE



SIZE	ID	OD	SL	h	H
1/2"	16.08	21.26	12.70	41.3	138
3/4"	22.45	27.63	17.78	41.3	138

1"	28.83	42.8	22.86	41.3	135
----	-------	------	-------	------	-----

SHORT CONCEALED VALVE



SIZE	ID	OD	SL	h	H
1/2"	16.08	21.26	12.70	41.3	109
3/4"	22.45	27.63	17.78	41.3	109
1"	28.83	42.8	22.86	41.3	105

CPVC CONCEALED DIVERTER - SHOWER & SPOUT

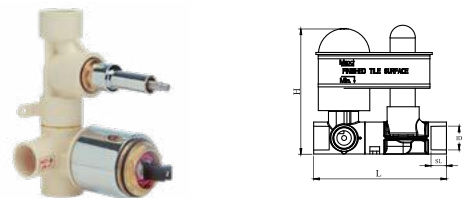

SIZE	ID	SL	L	H
3/4"	22.45	17.78	137.60	121.5

CPVC CONCEALED DIVERTER - SHOWER



SIZE	ID	SL	L	H
3/4"	22.45	17.78	67.50	121.5

BUTTERFLY VALVE

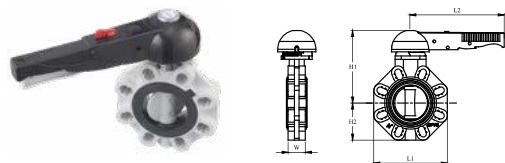

SIZE	ID	L1	H1	H2	L2	W	U
1 1/2"	40.5	132	155	62.5	175	30	4
2"	50.5	147	157	72	175	38	4
2 1/2"	65	147	112	70	175	43	4
3"	80	165	119	80	175	46	4

4"	100	185	133	93	272	49	8
6"	125	211	147	107	272	56	8

BALL VALVE

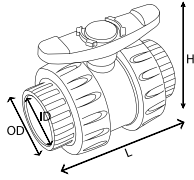

SIZE	ID	OD	H	L
2½"	73.38	83.68	138	230
3"	89.31	100.29	138	252
4"	114.76	126.80	171	295

BUTTERFLY VALVE BOLT & NUTS

SIZE	L
M12	125 MM
M16	125 MM
M16	150 MM
M16	160 MM

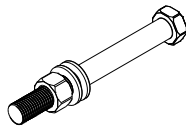

**ASHIRVAD FLOWGUARD® PLUS™
1 STEP CPVC SOLVENT CEMENT YELLOW
COLOURED - HEAVY BODIED**



SIZE (OZ)	SIZE (ML)	TUBE
0.5	15.0	TUBE
1	29.5	TUBE
2	59.0	TUBE

**ASHIRVAD FLOWGUARD® PLUS™
1 STEP CPVC SOLVENT CEMENT YELLOW
COLOURED - MEDIUM BODIED**



SIZE (OZ)	SIZE (ML)	TIN
2	59	TIN
4	118.0	TIN
8	237.0	TIN
16	473.0	TIN
32	946.0	TIN

**2 STEP CPVC SOLVENT CEMENT ORANGE
COLOURED**



SIZE (OZ)	SIZE (ML)	TIN
HEAVY BODIED		
4	118	TIN
8	237	TIN
16	473	TIN
32	946	TIN

MEDIUM BODIED		
8	237	TIN

2 STEP CPVC PRIMER PURPLE COLOURED



SIZE (OZ)	SIZE (ML)	TIN
PRIMER		
8	237	TIN

NUMBER OF JOINTS PER LITRE OF SOLVENT CEMENT

Diameter of Pipe (inch)	Approx. no. of joints/ litre of solvent cement
½"	300
¾"	200
1"	125
1¼"	110
1½"	90
2"	60
2½"	50
3"	40
4"	30
6"	10



The following notation (symbols) shall apply in this reference manual.

L - Length
W - Width
H - Height

T - Thickness
U - No. of holes
SL - Socket Length

ID - Inner Diameter
OD - Outer Diameter
WT - Wall Thickness

Thermal Effects

Expansion and Contraction

For CPVC pipes which are not embedded inside the wall but are carrying hot water from Boiler/Solar water heater etc., it is important to use ready made expansion loops supplied by Ashirvad Pipes. Use one Ashirvad expansion loop for every 12 feet run of the pipe, between two fixed joints.

For longer lines and longer distances between the fixed joints expansion loops can be made at site with calculations as per the FLOWGUARD® PLUS™ manual. Illustration for use and correct clamping is provided separately.



Use one company supplied expansion loop between two consecutive fixed joints (9-15 ft distance minimum)

Carrying Hot Water from Solar Heating System

Roof

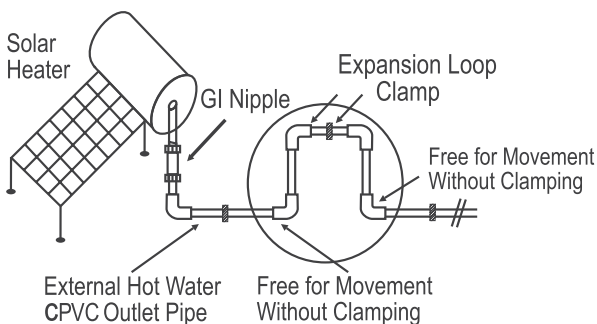

Apartment Building

External CPVC Pipe Carrying Hot Water from Solar Heater

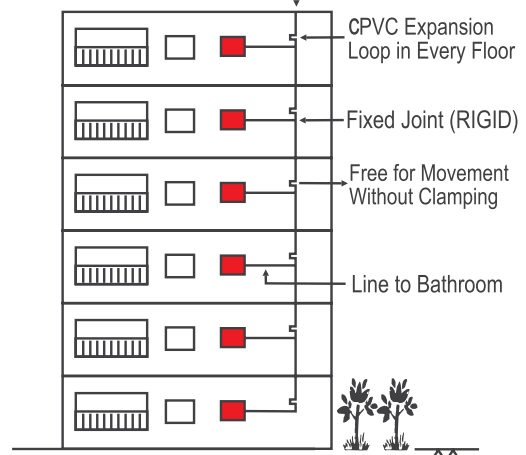

Correct installation in solar water heater lines



It is not recommended to directly connect CPVC pipes to the water heater outlet.

One meter long metal nipple should be connected directly to the heater so that the CPVC pipe is not damaged by the buildup of excessive radiant heat from the flue.

Heat loss prevention



In closed loop systems or plumbing systems with long run lengths, in order to conserve energy it may be recommended to use appropriate and compatible thermal insulation materials.

For further advise, please contact Ashirvad representative.

Horizontal and Vertical Spacing in Installation

A typical Hot and Cold water distribution system operating at 60° - 70°C requires support for horizontal lines every 90 cm for diameters below 32 mm and every 120 cm on larger sizes.

However the following spacings are based on assumptions and can be used at water temperatures indicated below.

Nominal in	Size mm	68°F feet	20°C mtr	122°F feet	50°C mtr	158°F feet	70°C mtr	176°F feet	80°C mtr
½	12.70	5.5	1.7	4.5	1.4	3.0	0.9	2.5	0.8
¾	19.05	5.5	1.7	5.0	1.5	3.0	0.9	2.5	0.8
1	25.40	6.0	1.8	5.5	1.7	3.5	1.1	3.0	0.9
1¼	31.75	6.5	2.0	6.0	1.8	3.5	1.1	3.0	0.9
1½	38.10	7.0	2.1	6.0	2.0	3.5	1.1	3.5	1.1
2	50.80	7.0	2.1	6.5	2.0	4.0	1.2	5.5	1.1
2½	63.50	8.0	2.4	7.5	2.3	4.5	1.4	4.0	1.2
3	76.20	8.0	2.4	7.5	2.3	4.5	1.4	4.0	1.2
4	101.60	9.0	2.7	8.5	2.6	4.5	1.4	4.5	1.4
6	152.40	10.0	3.0	9.0	2.7	5.5	1.7	5.0	1.5

VERTICAL PIPE

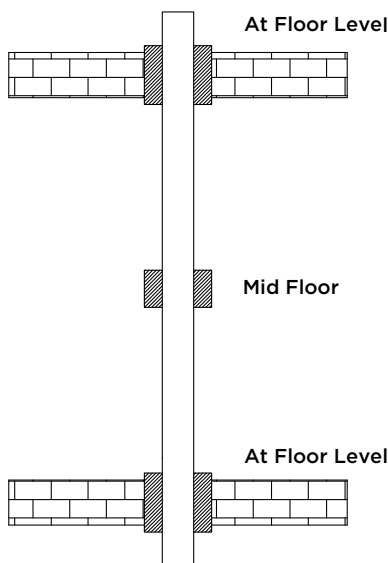

HORIZONTAL PIPE

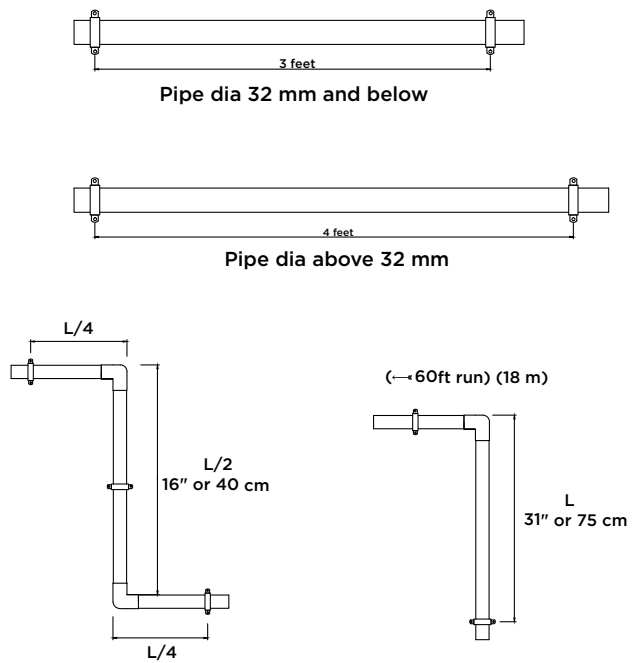

OFFSET

CHANGE IN DISTANCE

Do not butt up against fixed structures (joist, stud, wall)

Approximate Frictional Head Loss Table

Size In	Type	40	60	80	100	120	150	180	240	300	360	400	500
		Friction Loss	Friction Loss	Friction Loss	Friction Loss	Friction Loss	Friction Loss	Friction Loss	Friction Loss	Friction Loss	Friction Loss	Friction Loss	Friction Loss
½	SDR 13.5	167.17	354.24	603.51	912.36	1278.82	1933.2	2709.7	4616.5	6979.0	9782.2	11889.9	17974.5
¾	SDR 13.5	27.20	57.63	98.19	148.44	208.06	314.5	440.8	751.12	1135.51	1591.60	1934.5	2924.5
1	SDR 13.5	7.42	15.72	26.78	40.49	56.76	85.81	120.27	204.91	309.77	434.20	527.76	797.84
1¼	SDR 13.5	2.80	5.93	10.10	15.28	21.42	32.38	45.39	77.33	116.90	163.85	199.16	301.80
1½	SDR 13.5	1.22	2.59	4.42	6.69	9.38	14.18	19.87	33.86	51.20	71.76	87.22	131.86
2	SDR 13.5	0.32	0.69	1.18	1.78	2.50	3.78	5.30	9.03	13.65	19.13	23.26	35.16
½	SDR 11	211.97	449.15	765.21	1156.81	1621.46	2451.2	3435.7	5853.4	8848.9	12403.2	15075.7	22790.5
¾	SDR 11	31.99	67.78	115.48	174.58	244.70	369.9	518.52	883.39	1335.46	1871.87	2275.2	3439.51
1	SDR 11	9.13	19.35	32.98	49.85	69.88	105.6	148.08	252.28	381.38	534.57	649.76	982.27
1¼	SDR 11	3.43	7.277	12.39	18.74	26.27	39.71	55.67	94.84	143.38	200.97	244.27	369.28
1½	SDR 11	1.49	3.177	5.41	8.18	11.47	17.33	24.30	41.40	62.59	87.73	106.64	161.21
2	SDR 11	0.39	0.84	1.43	2.17	3.04	4.60	6.45	10.99	16.62	23.30	28.32	42.81
2½	SH 40	0.06	0.144	0.245	0.370	0.519	0.785	1.101	1.876	2.836	3.975	4.831	7.304
3	SH 40	0.023	0.050	0.085	0.128	0.180	0.273	0.382	0.652	0.985	1.381	1.679	2.539
4	SH 40	0.006	0.013	0.022	0.034	0.048	0.072	0.102	0.173	0.262	0.368	0.447	0.676
6	SH 40	0.0009	0.0018	0.003	0.0047	0.0066	0.0099	0.0139	0.0237	0.0358	0.0502	0.0610	0.0922
2½	SH 80	0.0915	0.1938	0.330	0.4992	0.6997	1.0578	1.4827	2.5261	3.8188	5.3527	6.5060	9.8353
3	SH 80	0.0311	0.066	0.1124	0.1699	0.2381	0.3600	0.504	0.8596	1.2995	1.8215	2.2139	3.3469
4	SH 80	0.0081	0.0171	0.029	0.0441	0.0618	0.0934	0.1309	0.2231	0.3373	0.4727	0.5746	0.8686
6	SH 80	0.0011	0.0023	0.004	0.006	0.0084	0.0127	0.0179	0.0304	0.0460	0.0645	0.0783	0.1284

Frequently Asked Questions

1. How are Ashirvad FLOWGUARD® PLUS™ CPVC pipes and fittings aligned?

Ashirvad has made innovation for correct alignment of fittings with pipes during fitment. Elbows and fittings in 1/2", 3/4" and 1" have an alignment mould mark which should be matched with the red stripe on the pipe during solvent cement push fitment process. This is to ensure that in the concealed installations the water outlet fittings are perpendicular to the wall surface and to avoid any repair, breakage, etc. after the wall finishing has been completed. Since there is no reference surface available to the plumber during installation in unplastered walls, this Self Alignment System is very useful and convenient. Ashirvad's self alignment system also saves on the extra cost in correcting those non aligned joints.

This alignment mark on the plastic fittings is an innovation done for the first time in the world by Ashirvad and is design registered.

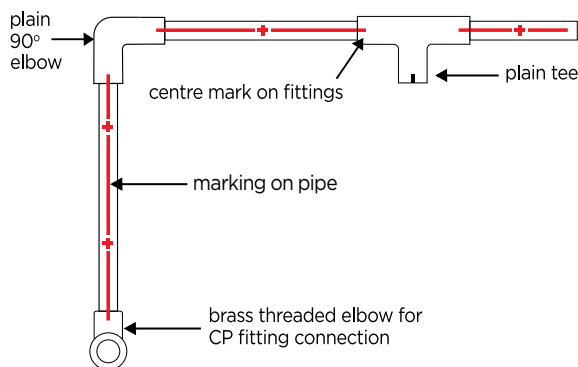

2. Is Ashirvad CPVC UV protected?

CPVC compound (supplied by Lubrizol) used for manufacture of pipes and fittings are already UV protected. More than 50 years of use has shown that there is no deterioration in pressure withstanding capacity of FLOWGUARD® PLUS™ CPVC pipes which have been installed under the sunlight, even after several years of installation. However, for extra protection for pipes which are directly under harsh sunlight, Ashirvad recommends covering all pipes and fittings installed on the roof to prevent any kind of mechanical damage to the system.

Additionally, a touch of Latex based paint which is water based can be beneficial to ensure no change in colour of pipe or printing. No oil / Solvent based paints are

to be used as these paints can drastically reduce the life of the systems.

3. How to repair the punctures in the wall chasing/concealed installations?

Repair of punctured and damaged pipe due to drilling/chiseling can be done by removing the solvent cement plaster and using the pipe repair piece supplied by the company. Thoroughly clean the area of pipe damaged and make it dry. Apply solvent cement on the surface of pipe at damaged portion in the entire circumference. Also apply solvent cement on the inner surface of pipe repair piece and snap on over damaged area. Tie a small piece of string/binding wire around the repair piece and pipe for sometime to allow to set. This is an unique system available with CPVC pipe where the damaged pipe need not be cut or shifted back and forth for repair. Do pressure test before replastering.

4. Do we need to insulate the CPVC pipes?

Thermal conductivity of FLOWGUARD® PLUS™ CPVC pipes and fittings is 0.14 W/MK whereas of copper is 400 W/MK. Since CPVC is a very bad conductor of heat, light insulation is recommended only for installations where there is a continuous flow of hot water e.g. solar/centralised heaters. In bathrooms with independent heaters within 3 meters location insulation may not be necessary.

Please ensure that the insulation material or glue being used to hold the insulation material does not contain any phthalate plasticiser as it is not compatible with CPVC and can cause failure to plumbing system in the long run.

- At the end of this section, a list of all incompatible materials with CPVC is given for ready reference.

5. How to prevent the damage due to drilling / hammering?

After concealing, like any other plastic/copper pipes FLOWGUARD® PLUS™ CPVC pipes and fittings are prone to damage and punctures due to drilling/hammering or chiseling. To avoid such accidents, piping route/layout diagrams and proper instruction may be given to the customer, tiling, carpentry and electrician teams. Also contrasting colour may be added to the solvent cement mortar used to fill the chasings.

6. Why to give the expansion loops in the solar heater hot water line?

For CPVC pipes which are not embedded inside the wall but are carrying hot water from boiler/solar water heater, etc it is most important to use ready made expansion loop supplied by Ashirvad Pipes. Use one ready made loop for every 9-12 ft. run of the pipe, between two fixed joints. The loops are designed for a max and min differential temp of 70°C. For longer lines and longer distances between the fixed joints expansion loops can be made at site with calculations as per the FLOWGUARD® PLUS™ manual or existing available loops can be used after every 12 feet length of pipe.

7. Can we use the combination of CPVC and uPVC piping system?

It is strictly advised to use CPVC pipes in all internal plumbing for both Hot and Cold water line. There has been instances of the non-return valve failure or pressure differential in Hot and Cold water line due to which hot water has entered in the cold line. If the cold water line pipe is not temperature resistant then it will lead to leakage or bursting causing huge loss and inconvenience to the customer.

8. At what distance do we need to clamp the pipes?

Please see previous section.

9. Is the water passing through the solvent cement joints safe for drinking?

Ashirvad CPVC FLOWGUARD® PLUS™ Solvent cements are NSF/ANSI 61 certified by IAPMO - India. So it is safe for drinking water applications.

10. How to support the pipe line during wall chase installations?

The installation may be supported with the help of pre-drilled 15 mm thick plywood piece, 6" long by 2" wide. After fixing the pipe in the wall chasing it may be supported by fixing the plywood piece over the pipe and the chasing. Only 3 to 4 such supports may be needed in one toilet/bathroom installation. During installation it is best to avoid contact between pipe and nails. Properly align and firmly grout all threaded fittings inside the chasing with strong mix of solvent cement and sand. Pipe line ends or elbows should be laid at least 2.5 cms. inside the wall surface.

11. Protection against household hot water storage geyser temperature and safety mechanism malfunction

Some plumbing codes contain detailed requirements for connections to gas or

electric storage type water heaters.

Determine whether your code has such requirements and satisfy them. CPVC can be piped to the electric water heaters with special metal-to-CPVC transition fittings as shown in the photo. For wall mounted electrical geyser connection always keep the inlet valve open and use flexible plastic hose pipe to connect geyser inlet to CPVC piping system. On gas water heaters there should be at least 6 inches of clearance between the exhaust flue and any CPVC piping. Twelve inch long metal nipple or appliance connector should be connected directly to the heater so that the CPVC pipe is not damaged by the build-up of excessive radiant heat from the flue. An approved temperature/ pressure (T/P) relief valve should be installed so that the probe or sensing element is in the water at the top of the heater. CPVC is approved by all the model codes for use as relief valve drain line piping. Use a metal-to-CPVC transition fitting to connect to the relief valve and continue the pipe full size to the outlet. For horizontal runs, slope the pipe toward the outlet and support it at three-foot centers or closer. The pipe must



CPVC pipe

Metal pipe

discharge to the atmosphere at an approved location. Do not use CPVC pipe and fittings with commercial-type non-storage water heaters.

12. What are the frictional losses encountered in CPVC systems?

Please see previous section for the table of frictional losses in CPVC systems.

13. Are any materials not compatible with CPVC systems?

Please see next section for the list of materials that are incompatible with CPVC.

14. Any suggestions on Pump Room Application?

Any pump, when switched on, initially if generates very high pressure.

This pressure may cause damage to initial fittings in the system. To avoid this damage following precautions to be followed:

- The ramp-up time to be increased. Because of increased ramp-up time, the pump gradually build the pressure. This will not damage the initial fittings in the system.
- Immediately after the pump, 1st and 2nd fitting used should be of metal.
- After the metal bends, the pipe and fitting

selection should be of Schedule 80, and jointing to be done with 2 step solvent cement.

d. Proper supports to be used provided to avoid the sagging of piping

15. Water Hammer Arrestor (WHA)

WATER HAMMER is the term used to define the destructive forces, pounding noises and vibration which develop in a piping system when a column of non-compressible liquid flowing through a pipe line is stopped abruptly. Fast closing positive shutoff valves incorporated in plumbing system all contribute to creating water shock which is not only annoying but damaging to pipes and appliances..

The Ashirvad Water Hammer Arrestors are designed to eliminate this effect. It features construction to comply with requirements. It incorporates a precharged, permanent sealed air chamber to absorb the shock. The sealed chamber prevents the loss of air to the water and assures long and trouble-free life.

Features :

- BSP solid hex brass adapter or solder end connection for easy installation.
- Approved for installation with no access panel requirement.
- May be installed in new or existing plumbing systems with a standard pipe tee vertically or horizontally.
- Maintenance free - piston is the only moving part.
- Air pre-load is 60psi (4.20 bar) in the chamber.
- Factory air charged and permanently sealed.
- Long lasting product.

Warranty and Incompatibility

Note on incompatibility

The following items are generally deemed incompatible with CPVC pipes and fittings as they can lead to environmental stress cracking or premature failure of the system. These materials are thus not to be used with FLOWGUARD® PLUS™ CPVC pipes and fittings.

1. Aggressive chemical agents
2. Fire stopping systems
3. Thread sealants
4. Insulation materials with phthalate plasticiser
5. Vaseline
6. Roofing tar
7. Silicone pipe sealants
8. Peppermint oil
9. Vegetable oil
10. Lubricants such as WD40
11. Insecticides
12. Leak detectors
13. Dioctyl phthalate (instead use foam polyethylene)
14. Liquid solvent cement
15. PVC pipe wrap tape
16. Acrylic latex caoul and silicone
17. Tiles and all purpose solvent cement caulk

The limited warranty will not apply if

1. Ashirvad products are used in combination with any other brand / make of pipes, fittings and solvent cement.
2. The product is used for purposes other than distribution of domestic water.
3. The product fails due to defects or deficiencies in design, engineering or installation.
4. The joints are not pressure tested before plastering of the casings.
5. The Installation manual for the use of the product is not followed.
6. The temperature exceeds 93°C for short term use and 82°C for continuous use.
7. The pipe is not warranted against any mechanical damage by nails, drilling, chiseling, etc.
8. The warranty will not apply in case of geyser short circuit or temperature control system failure.
9. For open hot water line, the expansion loop is not used as per instruction. For pipes under severe sunlight condition, coating of recommended paint to be done on pipes and fittings.

Ashirvad FLOWGUARD® PLUS™ CPVC limited warranty

Ashirvad Pipes Pvt. Ltd., Bengaluru warrants to the original owner that the product will be free from manufacturing defects and conform to current applicable ASTM standards under normal use. Buyers' remedy for breach of this warranty is limited to replacement of, or credit for, the defective product. This warranty excludes any expense for removal or reinstallation of any defective product and any other incidental, consequential or punitive damages.



LEAK PROOF BATHROOMS

Ideal for use in hot and cold water applications in villas and individual homes, residential apartments, office complexes, commercial buildings, hotels and hospitals.



TM & PATENT: Any unauthorized use, copying, manufacturing etc. of the similar product or technology of the invention protected will attract legal actions including, imprisonment or fine under relevant IP laws • Printed in 2020 • All rights reserved. No part of this publication may be copied, modified, reproduced in any material from (including photocopying or storing it in any medium by electronic means and whether or not transiently or incidentally to some other use of this publication) without the written permission of the copyright owner. Applications for the copyright owner's written permission to reproduce any part of this publication should be addressed to the copyright owner. **Warning:** The doing of an unauthorized act in relation to a copyright work may result in both a civil claim for damages and criminal prosecution. **Disclaimer:** Due care and diligence has been taken while editing and printing the book. Neither the author nor the publishers of the book hold any responsibility for any mistake that may have inadvertently crept in. Publishers shall not be liable for any direct, consequential, or incidental damages arising out of the use of the book. In case of binding mistake, misprints, or for missing pages etc. • Printed and bound in India. Moral Rights of the Author are asserted • The copyright owner reserves all rights and liberty to modify, change or alter the design drawings of the products as and when it deems appropriate and necessary without any prior notice to the users.

All rights reserved copyright © 2020 Ashirvad Pipes Private Limited

Ashirvad Pipes Pvt. Ltd., 4-B, Attibele Industrial Area, Hosur Road, Bengaluru - 562 107, Karnataka, INDIA.

T: +91 80 2806 1000 / 2806 1700 **F:** +91 80 2806 1080

For any Service / Customer complaint / Queries:

Toll Free: 1800 572 8900 **M:** +91 9902 333 333 **E:** customercare@ashirvad.com

SMART WATER MANAGEMENT PLUMBING . SANITARY . AGRICULTURE



by **alixis**



www.ashirvad.com